

CB13 GRAIN BIN ROOF

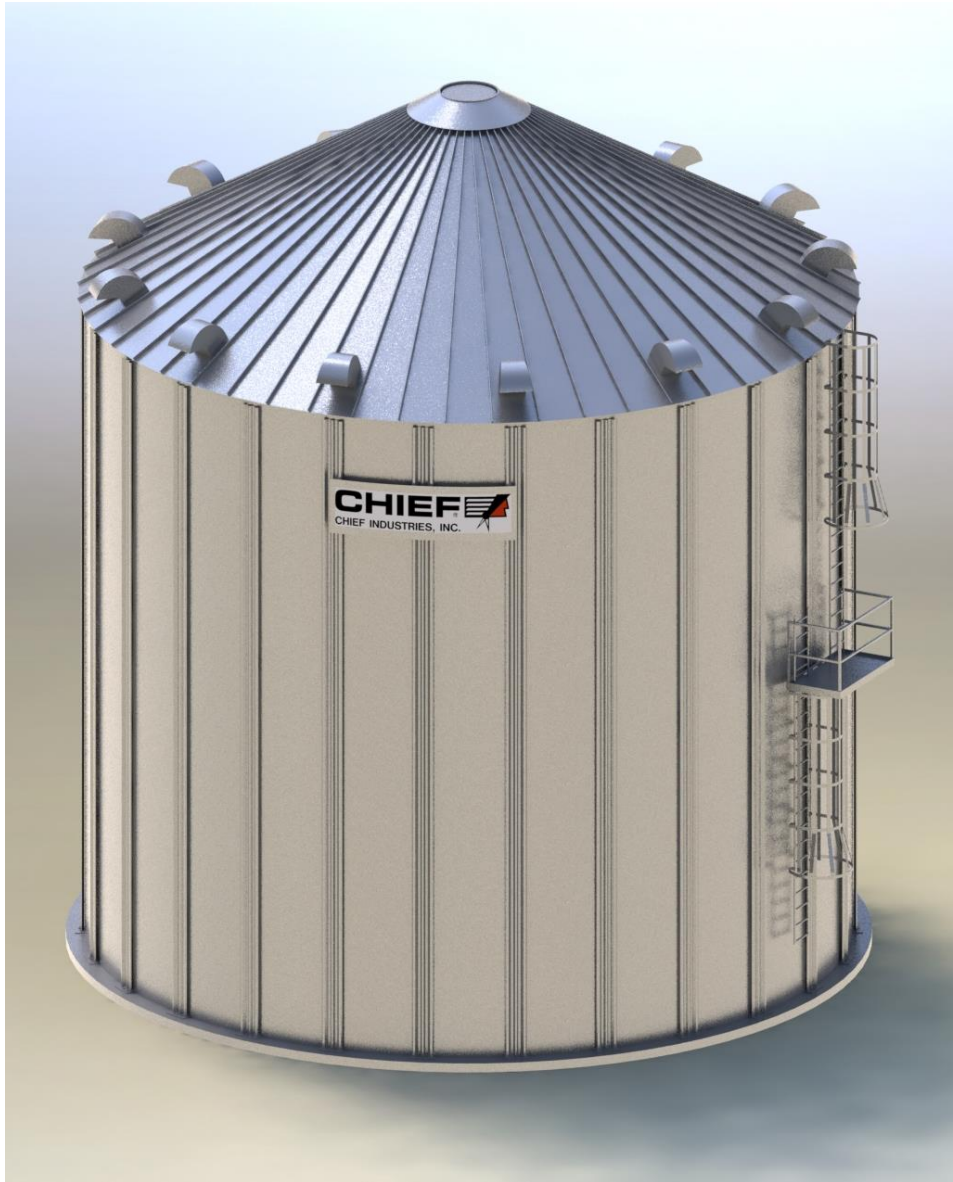

30 PSF Ground Snow Load
16,000 lb (7,257kg) Peak Load
40" Peak Diameter

INSTALLATION MANUAL

P/N 349000 Rev 0

CHIEF
AGRI

Trusted. Tested. True.®

Installation Manual



This symbol means “Attention! Be Alert! Your Safety Is At Stake!”

The safety alert symbol identifies safety messages for your storage structure and aeration floor. Ensure you are familiar with the messages identified for you with the safety alert symbol. When you see this symbol, be alert to the possibility of serious injury or death. Follow the safety instructions given in this manual and for your bin and aeration floor.

Danger: Indicates an imminently hazardous situation which, if not avoided, will result in death or serious injury.

Warning: Indicates a potentially hazardous situation which, if not avoided, could result in death or serious injury and property damage.

Caution: Indicates a potentially hazardous situation which, if not avoided, may result in minor or moderate injury. It may also be used to alert against unsafe practices.



WARNING: Improper installation, adjustment, alteration, service or maintenance can cause property damage, injury or death. Read the installation, operating and maintenance instructions thoroughly before installing or servicing this equipment.

This manual is for the installation of Chief Grain Bins effective 1/1/2016.

© Chief Industries, Inc.
4400 East 39th Street • PO Box 848
Kearney, NE 68847
Phone 800.359.7600

For more information about Chief Industries, Inc. and additional products or services please visit our website
www.agri.Chiefind.com

Table of Contents

Before You Begin	5
Safety and Precautions	6
General Contractor Responsibilities	7
Concrete Design and Construction	7
Accessory Equipment	8
Field Modifications and Installation Defects	8
Packing List.....	8
Color Codes	8
Suggested Equipment.....	9
Crane Weight Capacity	9
Peak Height for Roof Installation	10
Prior to Installation	11
Part Identification	11
Installation Procedures	13
Assembly Bolting Sequence	14
Roof Structure Installation.....	15
Roof Panel Installation	23
Roof Accessory Installation.....	29
Roof Peak Lid	29
Manhole Cover.....	30
Roof Working Ring.....	32
Roof Ladder	32
Gooseneck Vents.....	35
Low Profile Vents	36
Mushroom Vents.....	37
Safety Tie-Off Access Packages	38
Temperature Cable Packages	39
Manual Revisions	44
STANDARD LIMITED WARRANTY	45

Introduction

Thank you for purchasing a Chief grain bin. Proper installation and operation will ensure you the best overall experience with your grain bin and guarantee smooth operation.

This proprietary information is loaned with the expressed agreement that the drawings and information therein contained are the property of Chief Industries, Inc. and will not be reproduced, copied, or otherwise disposed of, directly or indirectly, and will not be used in whole or in part to assist in making or to furnish any information for the making of drawings, prints or other reproduction hereof, or for the making of additional products or equipment except upon written permission of Chief Industries, Inc. first obtained and specific as to each case. The acceptance of this material will be construed as an acceptance of the foregoing agreement.

The technical data contained herein is the most recent available at the time of publication and is subject to modification without notice. Chief Industries, Inc. reserves the right to modify the construction and method of operation of their products at any time without any obligation on their part to modify any equipment previously sold and delivered.

Model Number Description

The model nomenclature distinguishes the application of the grain bin. The information includes a designation of the applicable structure diameter, eave height, roof design and design criteria utilized. The definition of the model number nomenclature is as follows:

Example: CB 13 - 14 - J Rib - SZA
 (a) (b) - (c) - (d) - (e)

- (a) CB = Chief Bin
- (b) 13 = Grain Bin Diameter
Where: 13 = 13 sheets in circumference
- (c) 14 = Grain Bin Eave Height
Where: 14 = 14 sheets in height
- (d) J Rib = Roof Design Type
Where: J Rib = J Rib design
Where: V Rib = V Rib design
- (e) Grain Bin Design Criteria for seismic and wind



Before You Begin

Read this manual thoroughly before using this grain bin. Keep this manual in a location for quick access and reference.

The installation of the grain bin may require field fastening for some components. When using a cutting torch or welding galvanized material, the possibility of developing toxic fumes will exist. Provide adequate ventilation and respiratory protection when using this type of equipment during installation.

Special Service Note: If you are unable to remedy any service problem after thoroughly studying this manual, contact the dealer from whom you purchased the unit. Your dealer is your first line of service. The following information is required for service:

1. Bin model number: _____
2. Diameter and eave height of bin: _____
3. Grain depth: _____
4. Type of grain stored: _____
5. Dealer purchased from: _____
6. Dealer address and phone number: _____
7. Date purchased: _____
8. Service contractor:
 - a. Name: _____
 - b. Address: _____
 - c. Phone: _____



WARNING: Water Sensitive Materials - Read this notice carefully

Bundles must be inspected and carrier advised immediately if damage is noted. White rust will attack painted as well as galvanized sheeting. If water has entered a bundle or if condensation has formed between sheets, the bundle must be opened, the sheets separated and all surfaces dried.

If sheets are to be installed within 10 days:

Store bundled sheets of the ground high enough to allow air circulation beneath bundle and to prevent water from entering. Store 1 end at least 8" (20.32cm) higher than the opposite end. Support long bundles in the center. Prevent rain from entering the bundle by covering with a tarpaulin, making provision for air circulation between the draped edges and the ground. **Note:** Do not wrap in plastic.

If sheets are not to be installed within 10 days:

Provide inside dry storage. Storage beyond 6 months is not recommended. If white rust is apparent upon receipt of shipment, notify Chief immediately. Damage to sheets, resulting from improper storage, will be the responsibility of the receiver.

Safety and Precautions

Your safety and the safety of others is a primary concern to Chief Industries, Inc. This manual was written to assist in the safe installation and operation of the grain bin.

It is your responsibility as the owner, builder, operator, or supervisor to know what specific requirements, precautions and hazards exist and to make these known to all personnel working with equipment or on the jobsite so that they can observe any necessary safety precautions.

All personnel, including the installation crew, must read and understand the information contained in this manual before starting construction. Chief Industries, Inc. is not responsible or liable for the misuse of equipment or operation of personnel or equipment in an unsafe manner.

Chief Industries, Inc. assumes no liability with respect to proper construction and inspection, assembly, or use of its products established under applicable laws, all of which is the sole responsibility of the purchaser and those authorized for the installation.

Follow all local and federal safety laws and regulations. Verify that all equipment and personnel conform to any applicable jurisdiction regulations.

Work Area Safety Statement

To ensure the safety of all individuals in the work area, only authorized and trained persons shall install, and maintain the grain bin.

Under no circumstances should unauthorized individuals be allowed to trespass or be present in the work area.

It shall be the duty of all operators to ensure that the work area is clean, organized and kept free of all debris and tools that might cause an accidental tripping or falling hazard.

Special care should be taken when working from unsafe heights. Common sense dictates that when conditions such as rain or wind prohibit the safe use of equipment, the installation be discontinued.

Chief Industries, Inc. strongly recommends that equipment meeting the current specifications be used, whether the individual operator is required by law to do so or not. Proper climbing equipment and a secured safety harness should be used at all times when performing operations work, installation or maintenance.

Field modifications without the authorization of the manufacturer may present unknown dangers to the operator and must be avoided.

Auxiliary Equipment Safety

You may decide to purchase and install “auxiliary equipment” made by other manufacturers. Chief Industries, Inc. has no control over the design and manufacture of this equipment. In view of this, at a minimum, we suggest you do the following:

1. Obtain, read and understand the instructions and safety cautions of the auxiliary equipment manufacturer. Be certain that all equipment is installed in agreement with those instructions.

2. Check with Chief Industries, Inc. to verify that your system is designed to support any additional loads supplied by the auxiliary equipment.
3. Obtain any applicable safety decals from the manufacturer and make certain they are displayed in a visible location.
4. Make certain that all electrical equipment is properly installed and grounded by a qualified electrician.
5. Check availability and operation of electrical lock out and emergency stop systems.
6. Be certain that all guards and shields are securely in place.
7. Store all operation / maintenance manuals in a safe place for future use.

General Contractor Responsibilities

It is the responsibility of the general contractor to verify that the complete storage structure system is constructed with quality workmanship and that all equipment is installed per the respective manufacturer's instructions. This includes the following:

- Bin
- Foundation
- Base sealing
- Grain transport equipment
- Aeration equipment
- Accessory equipment

In addition, the general contractor is responsible for the fitness of use of any system which he constructs. All accessory equipment incorporated into the system, from each respective equipment manufacturer, should be approved for the intended use.

Concrete Design and Construction

The suggested foundation designs shown in the installation manuals are based on the allowable soil bearing capacity of the undisturbed soil and should be certified by a licensed engineering firm. Using soil borings to determine the allowable soil bearing capacity, a professional engineer will need to be employed by the contractor to design the foundation and floor slab accordingly.

All suggested foundation designs must be approved by a licensed engineer in order to meet local governing building codes and local soil and weather conditions. Wall loads and floor pressure for Chief grain bins are available from Chief Industries, Inc., upon request.

Note: The finished floor surface must be level at the sidewall sheet location. Low spots in the perimeter wall elevation without adequate shimming can cause structural damage to the bin sidewall. Faulty concrete or missing shims will void the warranty.

The suggested concrete foundation designs must not be used in conjunction with unload and aeration tunnels. Concrete and reinforcing bar requirements must be determined by a certified professional engineer. The design must consider soil bearing capacity, soil consolidation, footing requirements, tunnel requirements and the interaction of all foundation components under loaded condition. Non-uniform settlement of the foundation can cause severe structural damage to the

storage structure and foundation. An improperly designed or constructed foundation will void all aspects of the warranty. It is the responsibility of the general contractor to verify that an adequate foundation is provided for the grain bin.

Accessory Equipment

Accessory equipment can be installed with the grain bin; however certain limitations and special considerations must be followed in order to maintain the warranty.

All accessory equipment should be installed and maintained in accordance with each individual supplier's installation and operation instructions. However, if any sidewall penetrations or other modifications to the Chief standard design are required, contact Chief for special recommendations.

Note: Do not modify the storage structure design without Chief approval. It is the responsibility of the general contractor to verify that all equipment is properly installed and that the equipment is compatible with the intended use. A qualified electrician should be contracted to complete all electrical wiring and servicing.

Field Modifications and Installation Defects

Chief Industries, Inc. assumes no responsibility for field modifications or installation defects which result in structural damage or storage quality problems. If any field modifications are necessary which are not specifically covered by the contents of the installation manual, contact Chief for approval. Any unauthorized modification or installation defect which affects the structural integrity of the grain bin will void the warranty.

Packing List

For your convenience in the installation all packages will be color coded, individual items labeled with an appropriate part number and packages labeled. Hardware, including bolts, nuts, screws and other small clips or brackets may be divided into smaller packages for ease of use and identification.

Verify and inspect all items carefully when unpacking and before installing. This should be done at the time of pickup or delivery. Compare the items to the packing list provided with the shipment. In case of any shortage or damage during shipment, note such shortage or damage on the freight bill before you sign the shipment paperwork and file a claim with the carrier.

Claims of shortages will not be honored after thirty days from receipt of shipment. Parts that are short or damaged are the responsibility of the delivering carrier, not the manufacturer or dealer.

It is advisable to reorder damaged or missing parts immediately so that there will be no delay in the bin installation. After receiving the invoice for the reordered material, file a claim with the delivering carrier immediately.

Color Codes

Chief grain bin components are color coded based upon gage thickness. Additional items such as roof components will also be marked with specific color codes for easy identification.

Suggested Equipment

Chief recommends the following equipment and tools needed for installation of the grain storage bin. Individual installations may vary.

- Impact wrenches and sockets
- End wrenches
- Crescent wrenches
- Vise grip pliers
- Alignment punches
- Rubber mallets
- Level
- Drill and drill bits
- Screw Guns
- Extension cords
- Ladders
- Bin Jacks

Crane Weight Capacity

Verify the total roof dead load. This weight includes the roof panels, all structural members and included hardware.

When determining the crane capacity necessary to install the roof structure, the boom distance must be considered. If a single crane will not lift the roof structure two cranes may be used, utilizing a spreader bar. The spreader bar must be adequately designed to carry the entire roof dead weight.

Note: Overloading the crane capacity can result in substantial property damage and severe personal injury. Always verify crane capacity prior to lifting roof structure.

Peak Height for Roof Installation

Position a structure to hold the inner ring at the approximate height, centering the inner ring at the center of the grain bin.

The peak heights listed below are to the bottom of the peak ring with 2 sidewall sheet rings installed. If 1 sidewall sheet ring is desired, deduct 42.50" (107.9cm) from the heights listed below.

Prior to Installation

Assemble the top 2 sidewall rings and stiffeners according to the instructions found in the grain bin installation manual. Refer to the Chief grain bin installation manual for specific instructions.

Part Identification

Use the following information to identify parts used during installation.

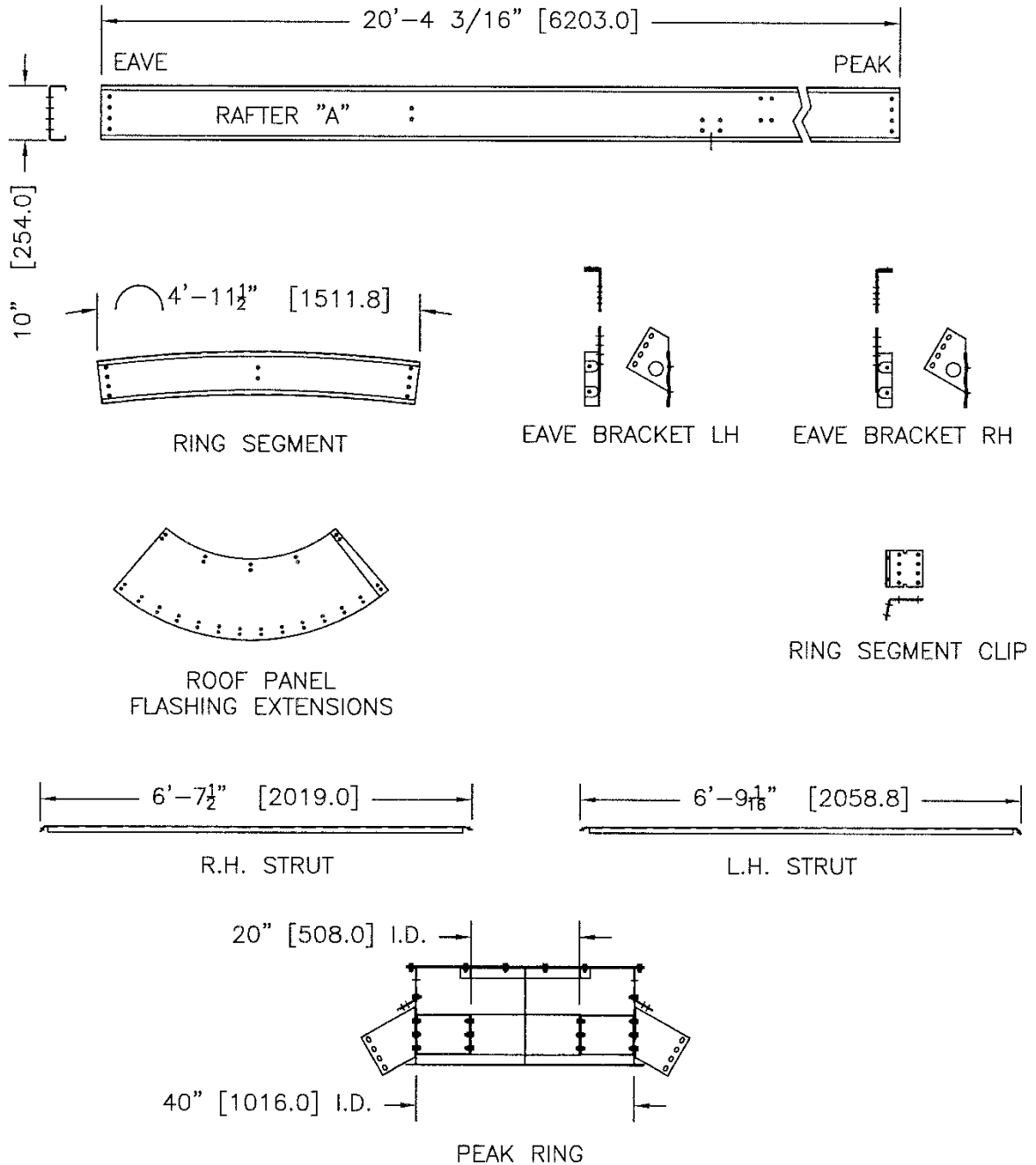

5/16" X 3/4"
BIN BOLT
#820589

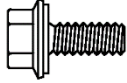

7/16" X 3"
BIN BOLT
#101703

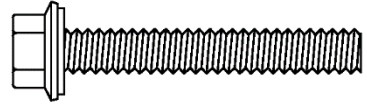

5/16" X 1-1/4"
BIN BOLT
#820605

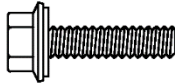

7/16" X 2"
BIN BOLT
#820878

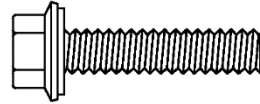

5/16" WHIZ
FLANGE NUT
#708206



7/16" X 1-1/2"
BIN BOLT
#820944

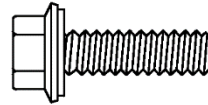

#12-24 X 1-1/2"
SELF-DRILLING SCREW
#820590



7/16" X 1-1/4"
BIN BOLT
#960811

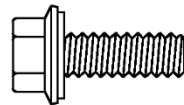

1/2" X 1-1/2"
BOLT
#464842

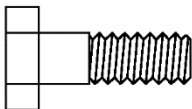

7/16" WHIZ
FLANGE NUT
#501635

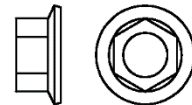

1/2" X 2"
BOLT
#708016

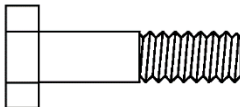

1/2" NUT
#963481

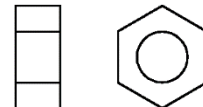

1/2"
FLAT WASHER
#708289

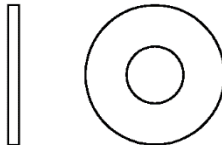

Installation Procedures

All exterior components are assembled using SAE grade 5 and 8 washer head bin bolts with sealing washers. Interior components do not use sealing washers. Whiz flange (serrated flange) nuts are used to secure the bolts in position.

If these descriptions do not correspond with the bolts shipped with the bin, please contact the customer service department immediately. Substitution of any other type or bolt grade or hardware from other sources is not allowed and will void the warranty.

When installing hardware the minimum and maximum torque values shown below must be followed. All hardware must seat tight against the corresponding bin component.

Bolt Diameter	Minimum Torque	Maximum Torque
5/16" (.79cm)	22 ft.-lbs.	28 ft.-lbs.
7/16" (1.11cm)	60 ft.-lbs.	75 ft.-lbs.
1/2" (1.27cm)	50 ft.-lbs.	58 ft.-lbs.
5/8" (1.58cm)	105 ft.-lbs.	121 ft.-lbs.
3/4" (1.90cm)	175 ft.-lbs.	201 ft.-lbs.

Install all bin bolts as shown in the following illustration.

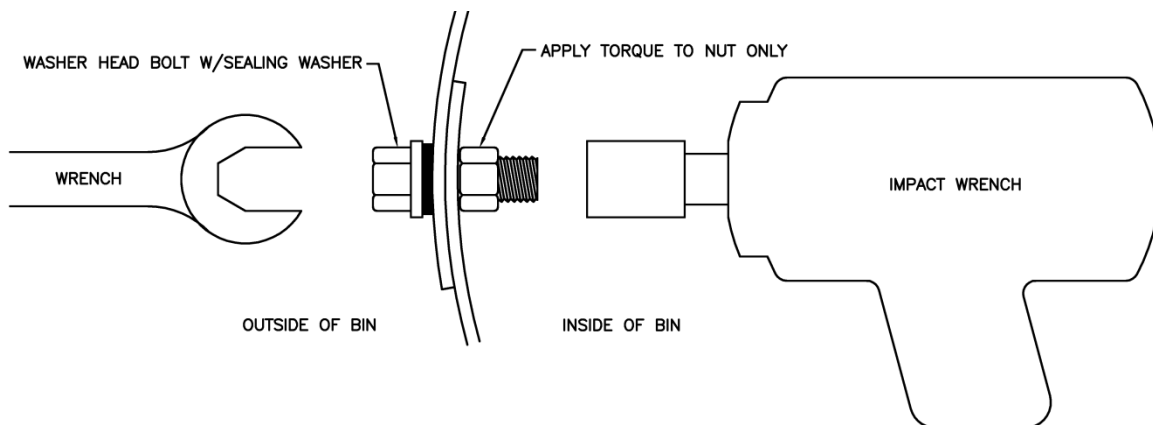

Please note the following wrench / socket size to be used on the corresponding hardware:

Bolt Size	Head Size	Nut Size
5/16"	1/2" wrench	1/2" wrench
7/16"	5/8" wrench	11/16" wrench
1/2"	3/4" wrench	3/4" wrench
5/8"	15/16" wrench	15/16" wrench
3/4"	1-1/8" wrench	1-1/8" wrench

Assembly Bolting Sequence

Install all components in the following order.

- Top angles
- Rafter A-frames.
 - Ring segment clips
 - Rafter reinforcing plates
 - Ring segments
 - Roof struts
 - X-brace clips
 - X-bracing
 - Eave brackets
 - Eave channel clips
 - Eave channels
- Roof panel standoffs
- Lower roof panels
- Upper roof flashing clips
- Upper roof panels
- Upper roof flashing extensions
- Cap flashing

Attach the top angle to the inside of the top sidewall ring using 5/16" x 3/4" (.79x1.90cm) bolts.

Note: There is 1 top angle per sidewall sheet.

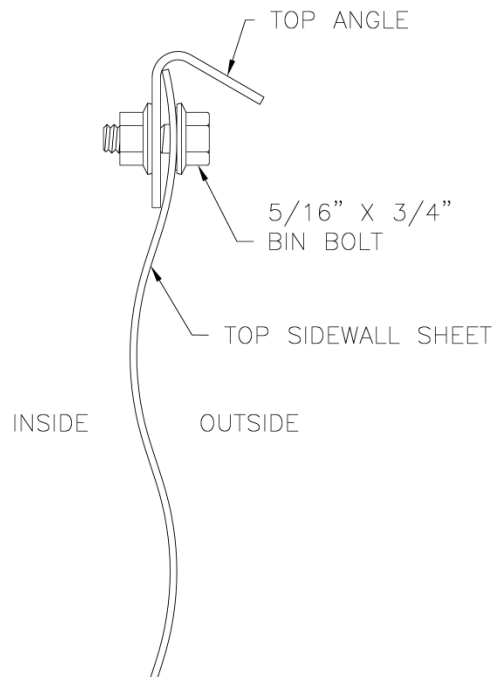

Roof Structure Installation

Pre-assemble the roof rafter A-frames as shown in the following illustration. Tighten all bolts in the A-frame structures prior to installing on the roof. **Note:** Extra holes should be filled in with 1/2"x1-1/2" (1.27x3.81cm) bolts.

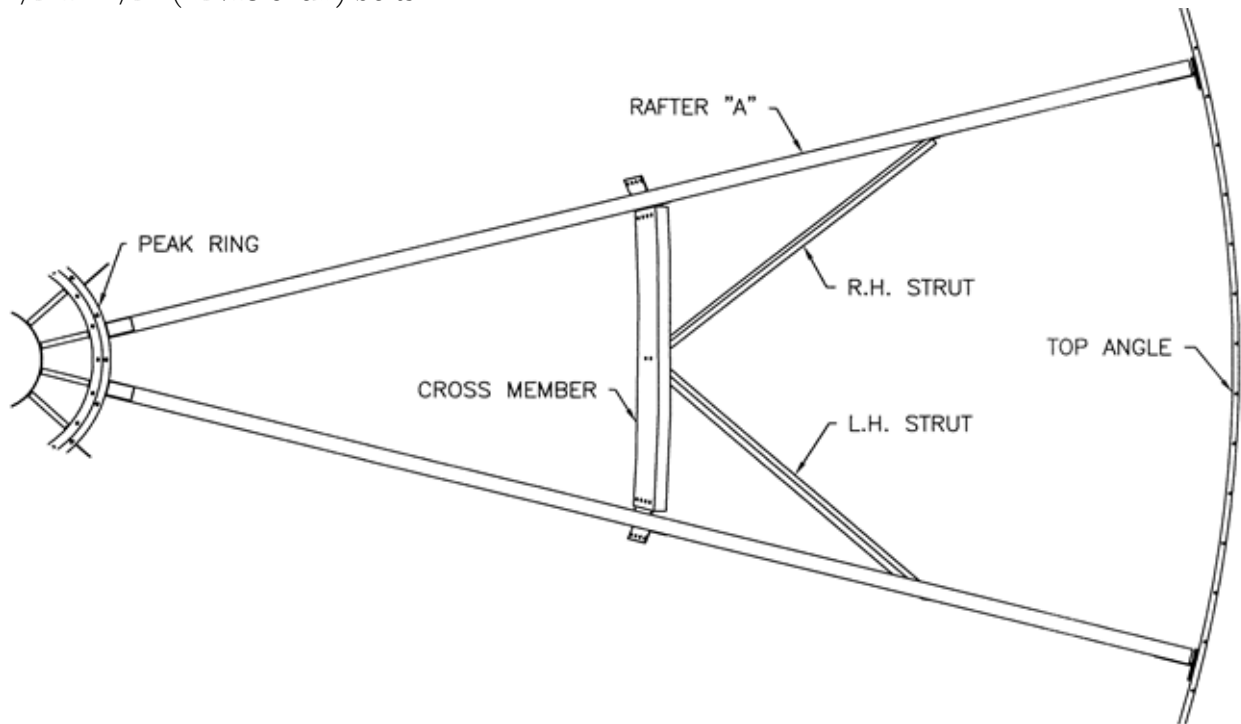

Attach the ring segment clips to every rafter as shown in the following illustration using 1/2" x 1-1/2" (1.27x3.81cm) bolts.

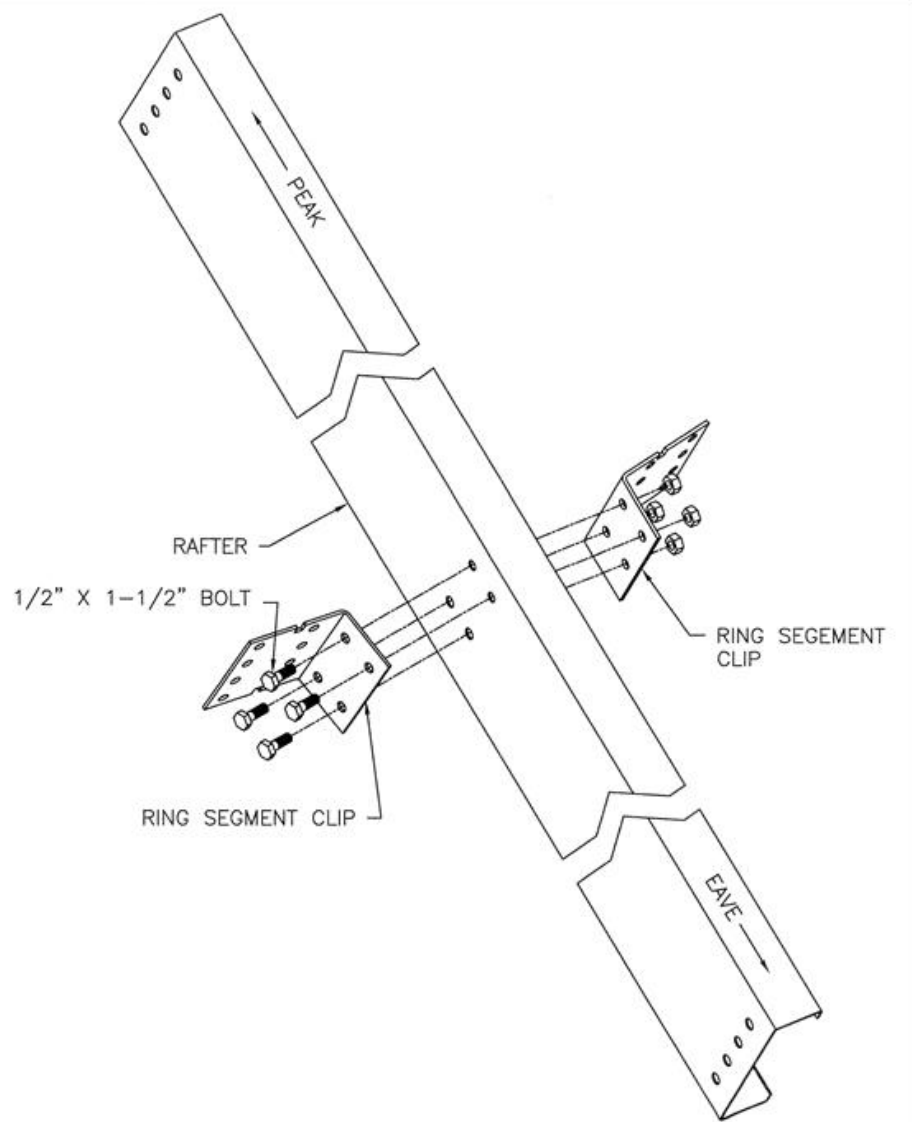

Attach the ring segments to the ring segment clips as shown in the following illustration using 1/2"x1-1/2" (1.27x3.81cm) bolts. **Note:** No washers are required on the ring segments.

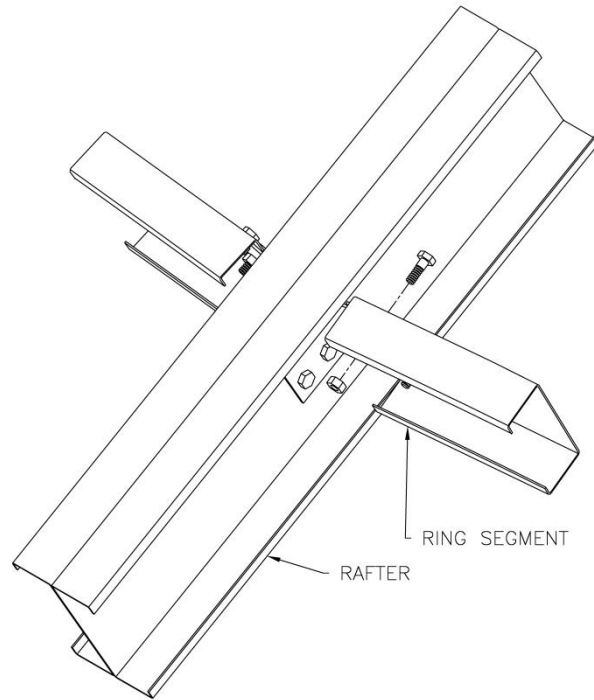

Located at the eave, looking upward towards the peak, verify the position of the ring segment on the clip is correct according to its position on the rafter.

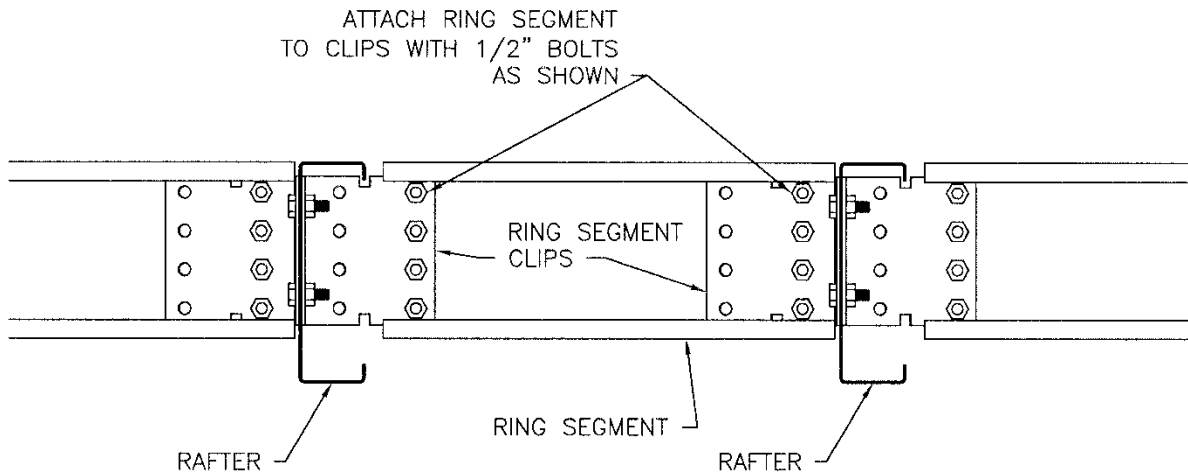

Attach the roof struts using 1/2"x1-1/2" (1.27x3.81cm) bolts. **Note:** Leave bolts loose on the rafter A-frames until the strut in the adjacent A-frame bay is installed.

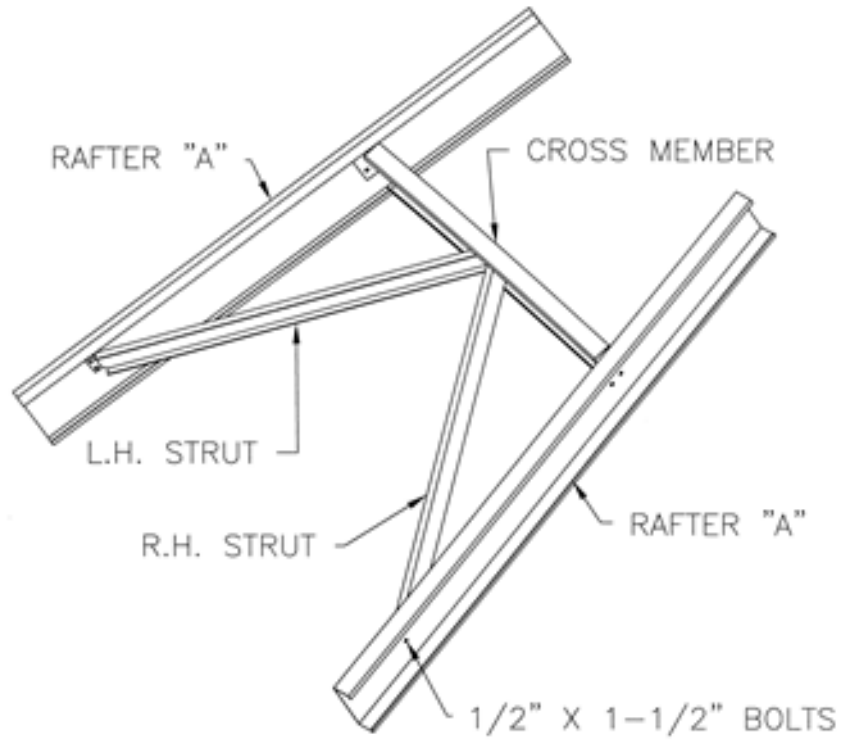

Attach the left hand and right hand eave brackets to the lower part of the rafter located at the bin eave. These eave brackets use 1/2"x1-1/2" (1.27x3.81cm) bolts.

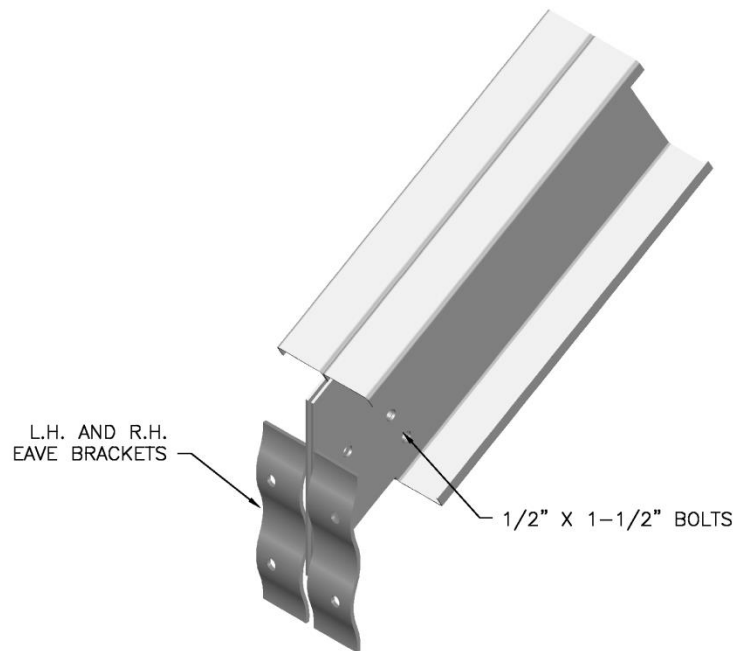

After all the A-frames are built, equally space and attach 4 frames to the peak ring and sidewall. Next attach a left hand and right hand eave bracket to the interior of the top sidewall sheet behind the 2 ring top stiffener using 7/16" x 1-1/2" (1.11x3.81cm) bin bolts with the bolt head located on the interior of the bin, as shown in the following illustration. **Note:** 1 left hand and right hand eave bracket is required per sidewall sheet equally spaced around the bin. On 3 stiffened bins, the rafters will be located on 1 and 2 ring top stiffeners.

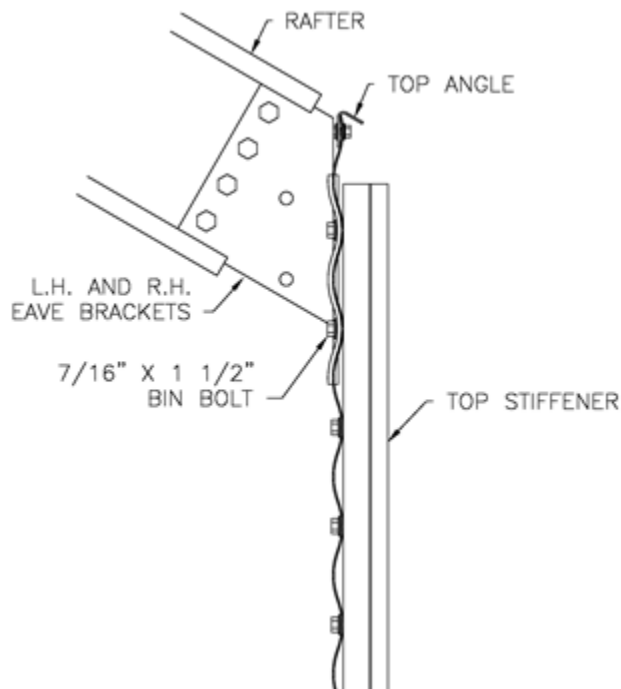

Attach the A-frame rafters to the peak brackets using 1/2"x1-1/2" (1.27x3.81cm) bolts with the washers located against brackets as shown in the following illustration.

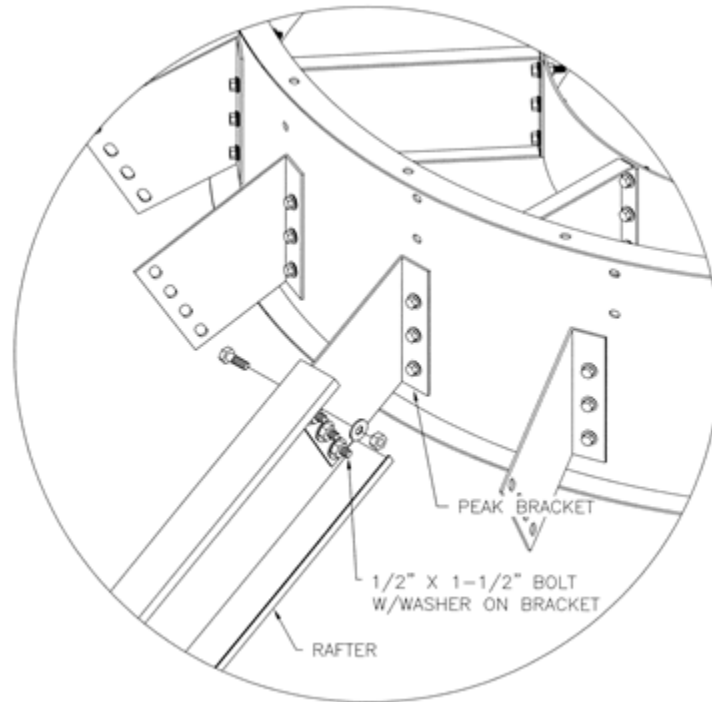

Once the 4 initial A-frames are installed verify that the peak ring is level, then continue installing the remaining A-frame rafter bays.

Once the installation of the A-frame bays are complete verify that the structure is identical to the following illustration.

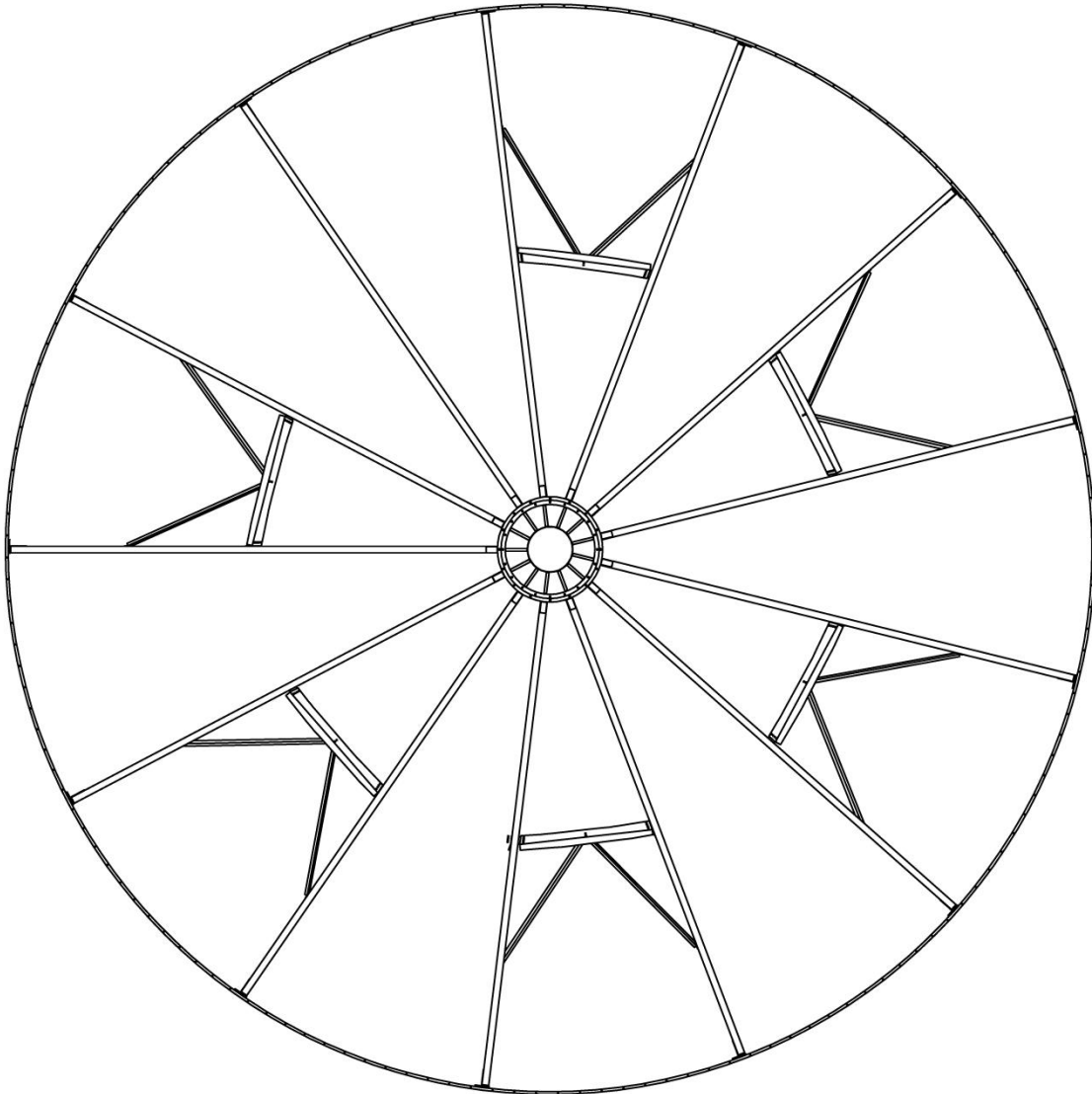

Next, after all the A-frame rafter bays are installed, begin installing the remaining ring segments and bracing. **Note:** Leave bolts loose until the remaining structure is installed, and then proceed to tighten all remaining hardware.

Once completed verify the roof structure is identical to the following illustration.

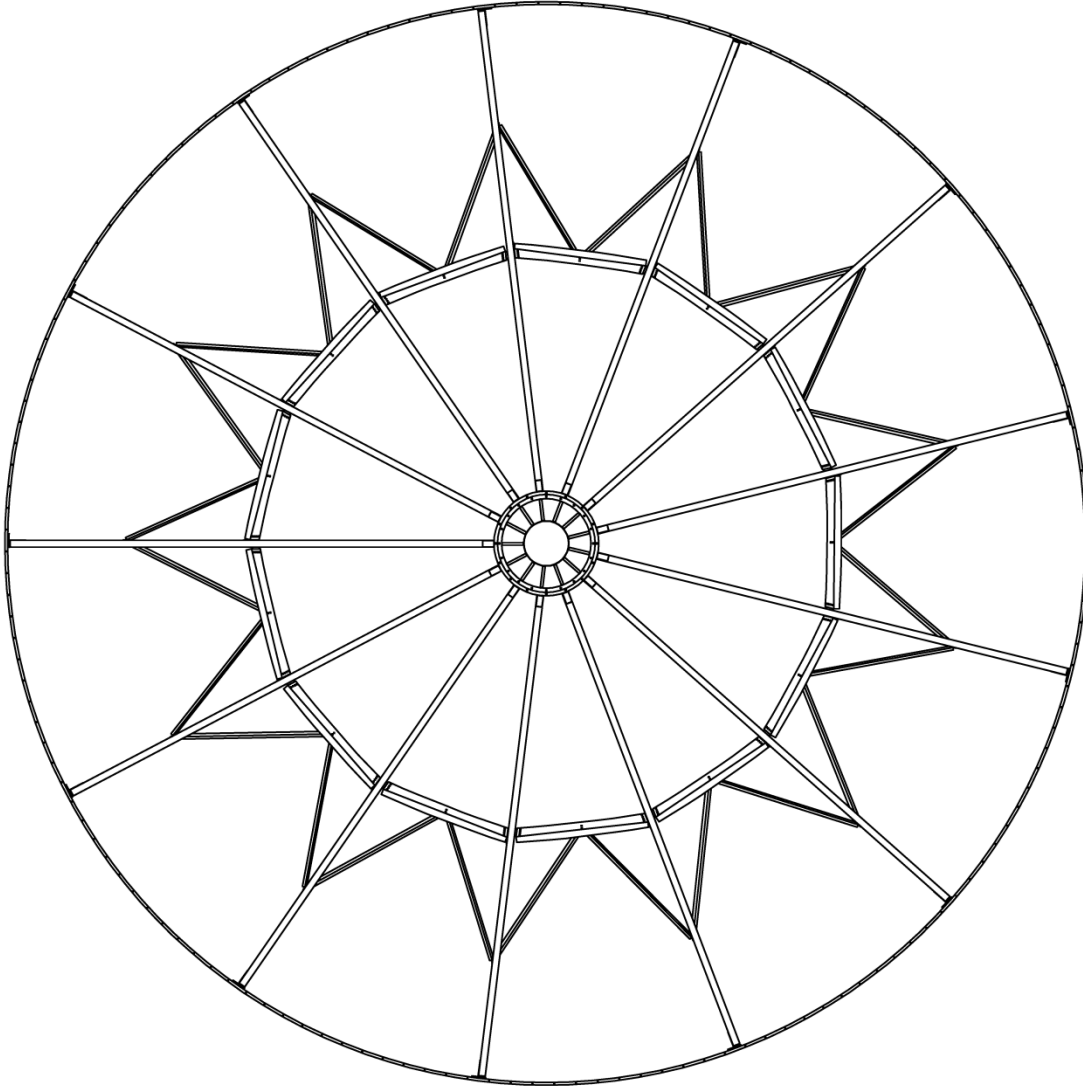

Roof Panel Installation

Locate the peak flashing clips and attach these to the peak ring with 7/16" x 1-1/4" (1.11x3.17cm) bin bolts. Place plastic foam around the peak ring underneath the flashing clips.

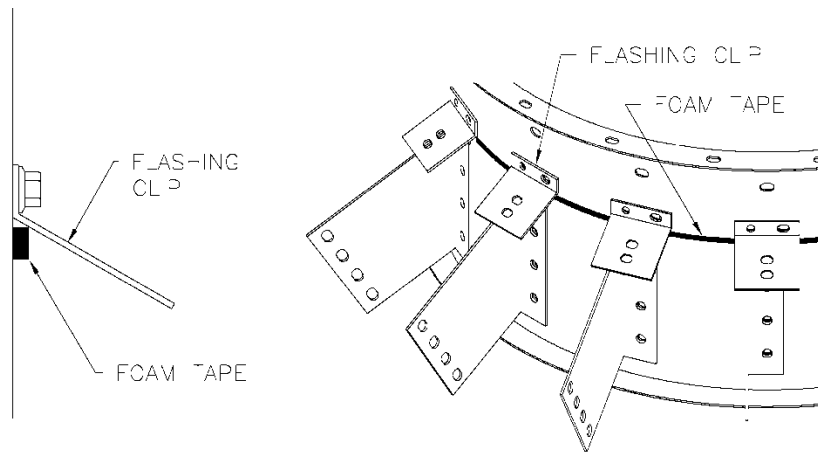

Install the roof panel flashing extensions as shown in the following illustrations. These extensions are fabricated in equal pieces and are installed in a clockwise pattern around the peak with 7/16" x 1-1/4" (1.11x3.17cm) bin bolts. The first flashing extension must be centered on the roof rafter and the flashing clip on the peak ring. **Note:** Flashing extensions must be oriented properly to correctly align roof panels.

Foam sealant is required on the edge of the flashing extension to create a watertight seal between components.

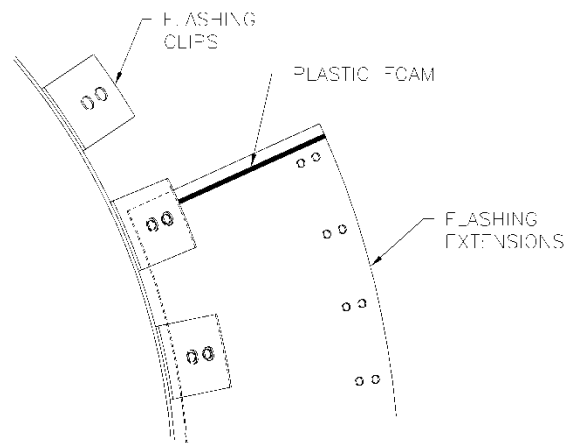

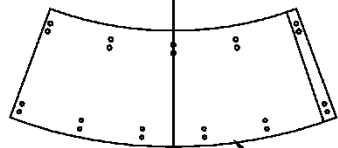
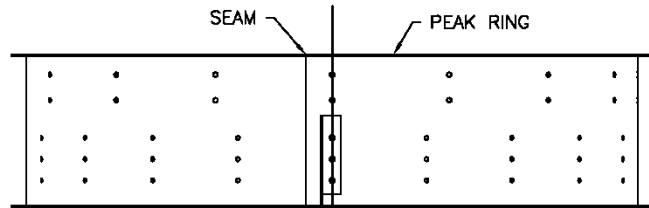
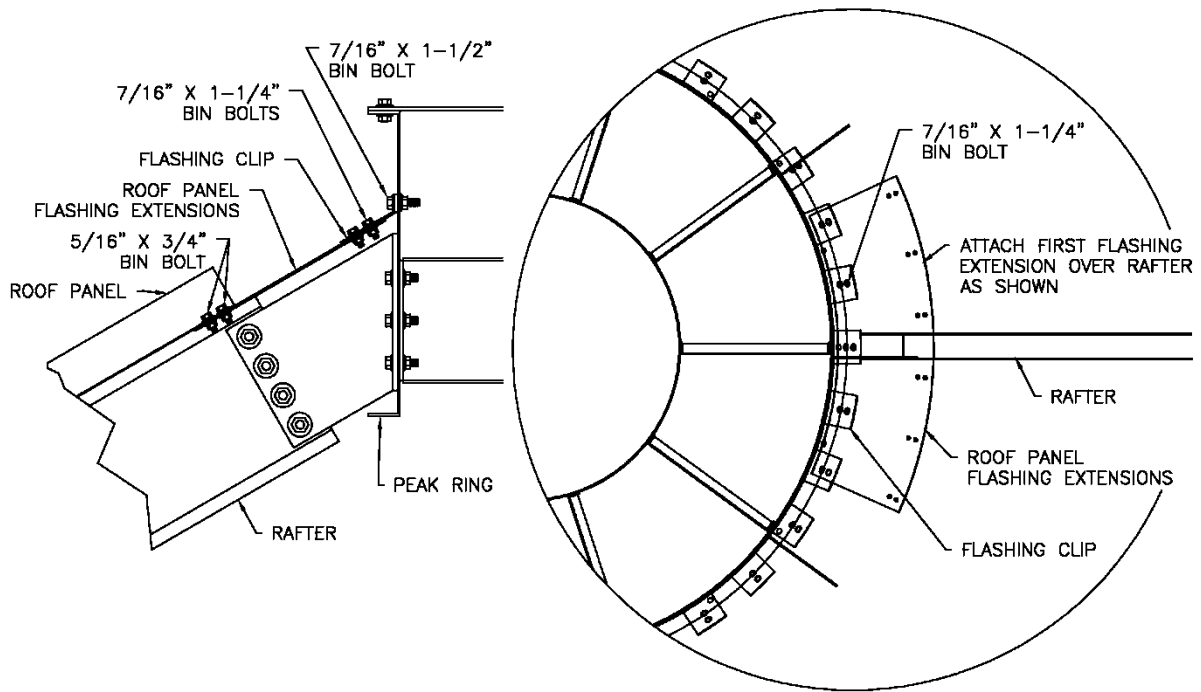

ROOF PANEL FLASHING EXTENSIONS
ATTACH FIRST FLASHING EXTENSION ON CENTER LINE OF PEAK RING AS SHOWN

Install roof panels in a counter clockwise direction, always working to the right around the bin. Place sealant on the top right rib of the previously installed roof panel. Position the roof panel in a vertical position and lock the left rib of the current panel over the right rib of the previously installed panel. Slowly rotate the roof panel down.

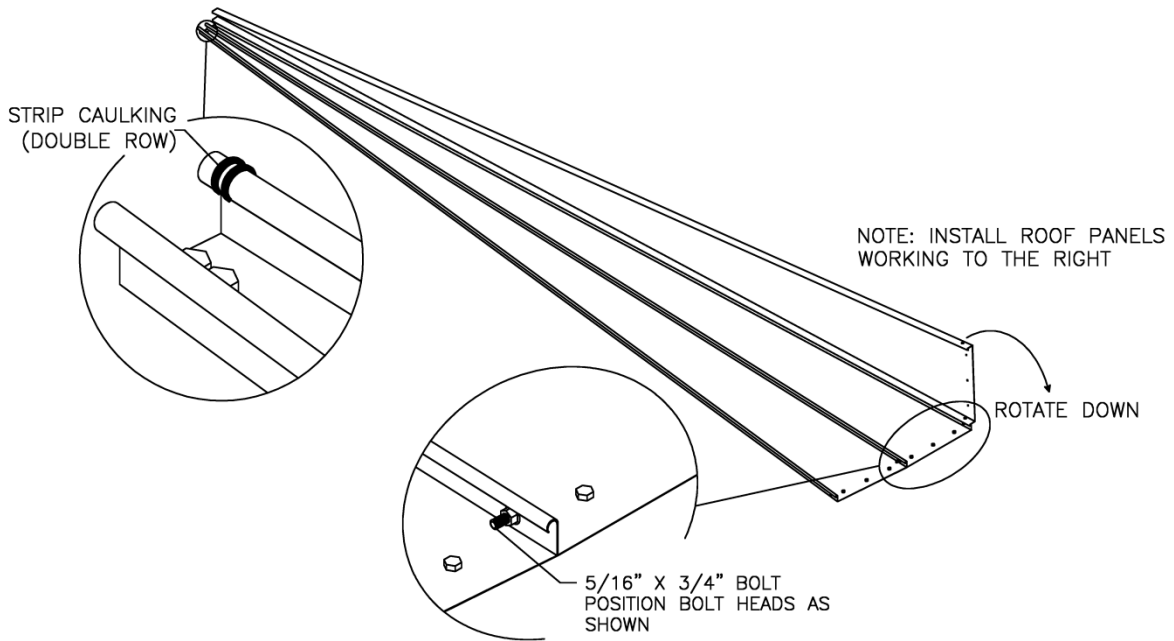

As each roof panel is set into place, insert an alignment punch through the hole in the rib at the bottom of each roof panel. Temporarily clamp the two roof panels together with vise grips so that the punch can be removed. Insert a 5/16" x 3/4" (.79x1.90cm) bolt and only hand tighten the hardware at this time.

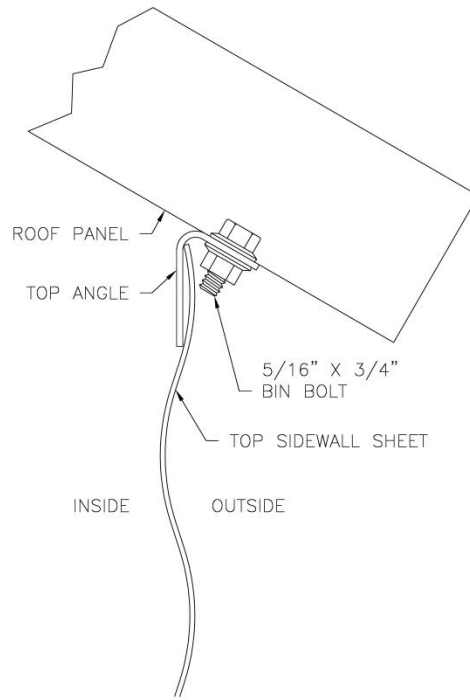

Continue the installation of the remaining roof panels as described previously. When the last roof panel is placed, it will have to be interlocked by using a rubber mallet. Starting at the top and working down the length of the panel, tap the vertical rib until it is locked to the other panel. Align roof panel holes tighten hardware as described previously.

Attach each roof panel to the ring segments using (2) #12 x 1" self-drilling screws per panel as shown. **Note:** Self drilling screws are required in the lower and upper ring segments.

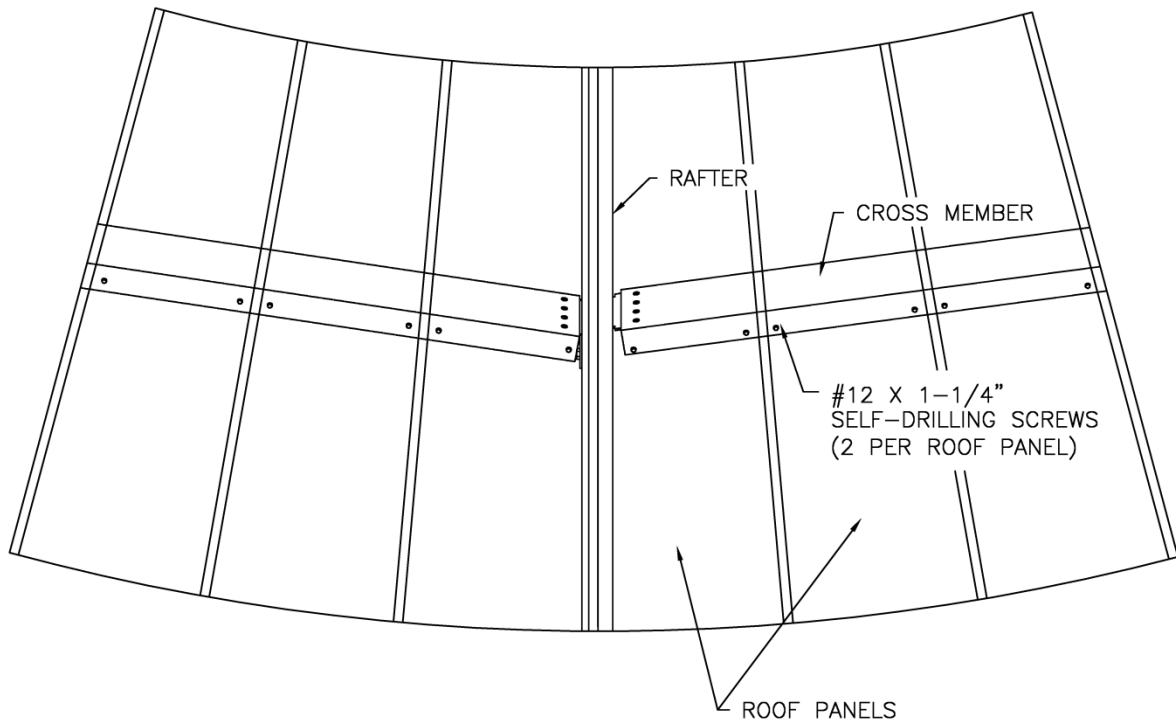

Install the cap flashing pieces to the peak ring with 7/16" x 1" (1.11x2.54cm) bin bolts.

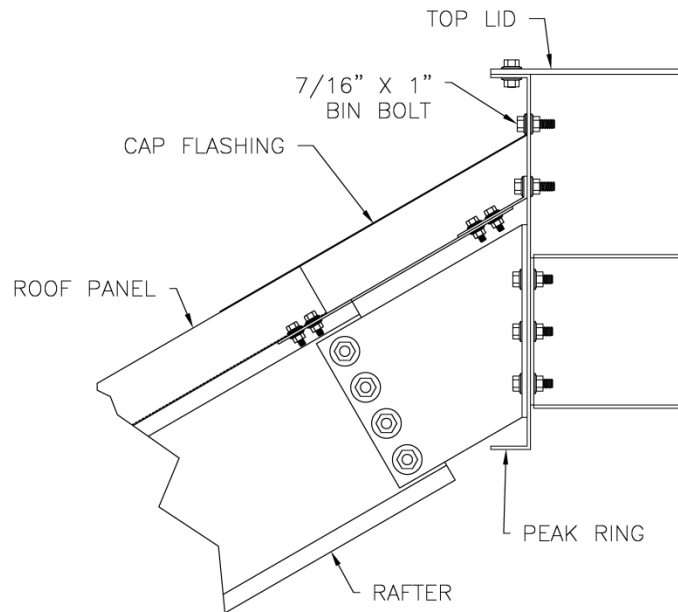

After the cap flashing pieces are attached to the peak ring, secure the cap flashing overlaps together with #12 x 1-1/4" self-drilling screws.

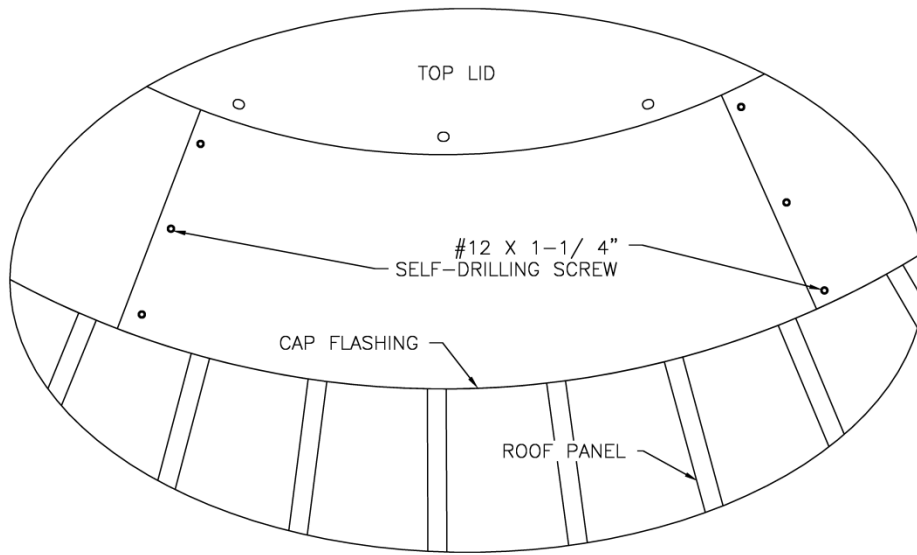

Roof Accessory Installation

Roof Peak Lid

Install the roof peak top lid by first applying sealant to the peak ring. Next secure the top lid with 7/16" x 1" (1.11x2.54cm) bin bolts as shown in the following illustration. Bolt heads will be to the top surface of the bin lid.

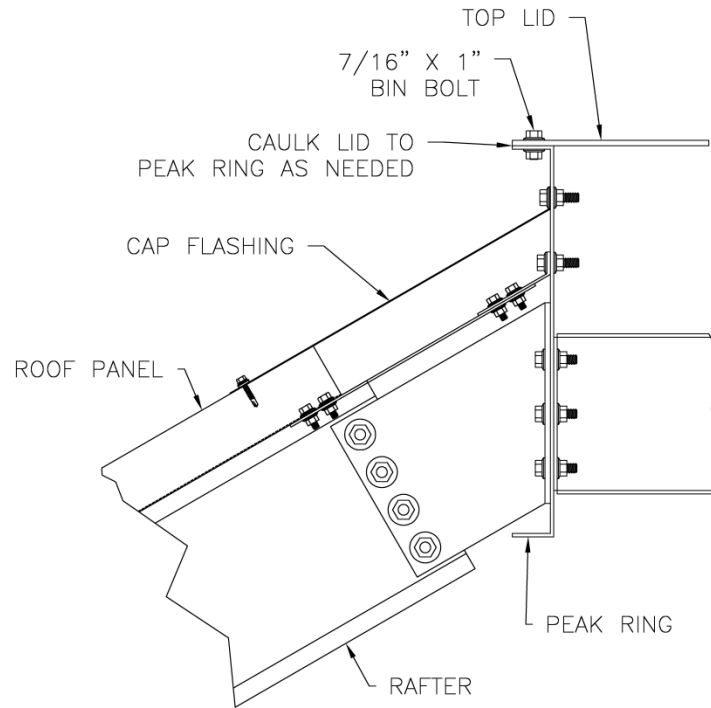

Manhole Cover

Install the manhole cover as shown in the following illustration. Verify that the hinge is located towards the bin peak. Secure the manhole cover with 5/16" x 3/4" (.79x1.90cm) bin bolts. The bolts connecting the hinge to the roof panel and the leaf bracket to the manhole cover will have the bolts heads located on the interior of the bin.

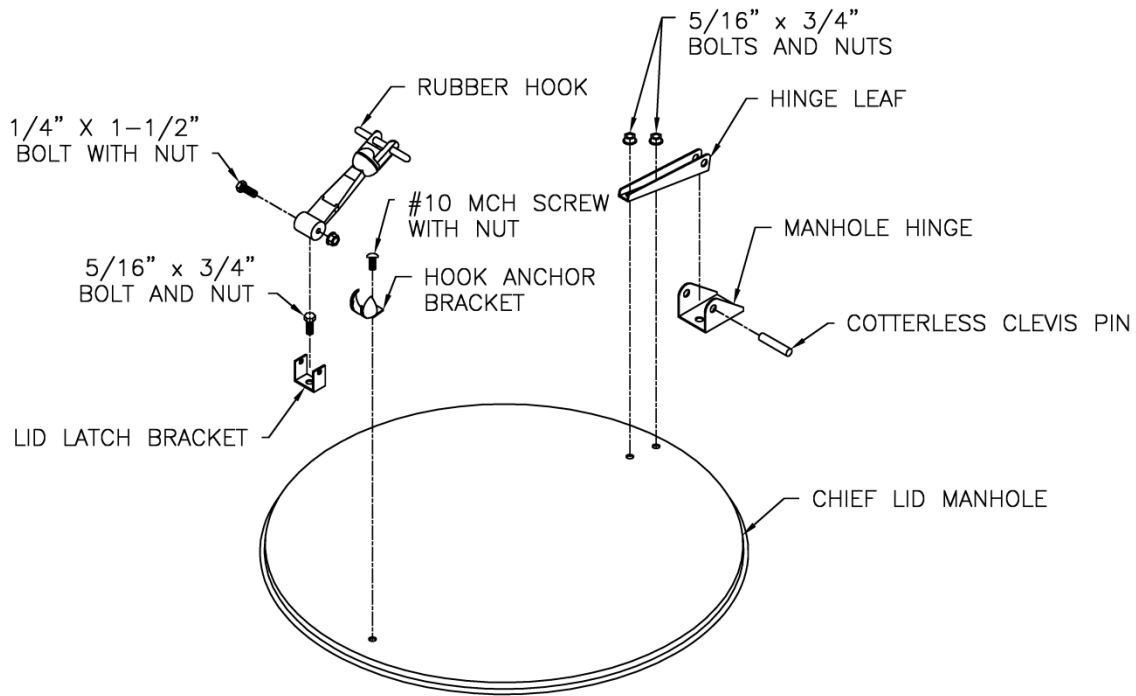

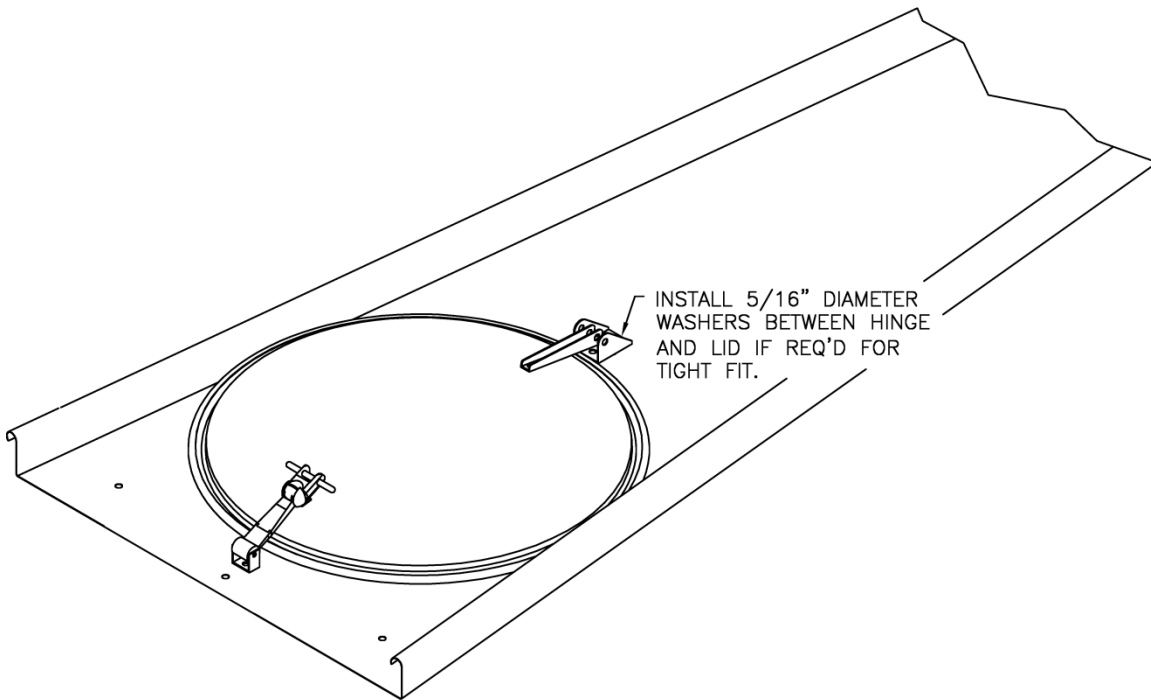
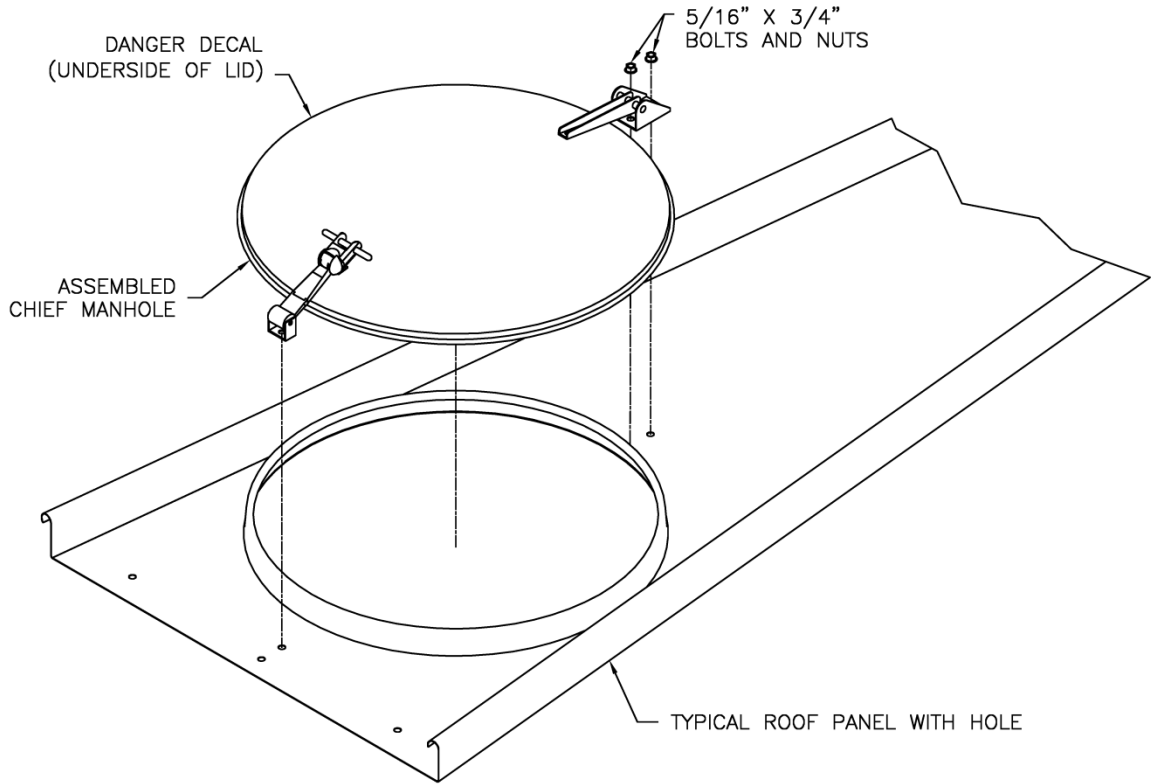

Roof Working Ring

Install the working ring as shown in the following illustration. Verify that the working ring brackets are equally spaced around the ring. The working ring segments will be connected with threaded rod and nuts, and must be expanded as needed to allow the ring to fit tightly against the brackets. Secure the working ring brackets with 5/16" x 3/4" (.79x1.90cm) bin bolts.

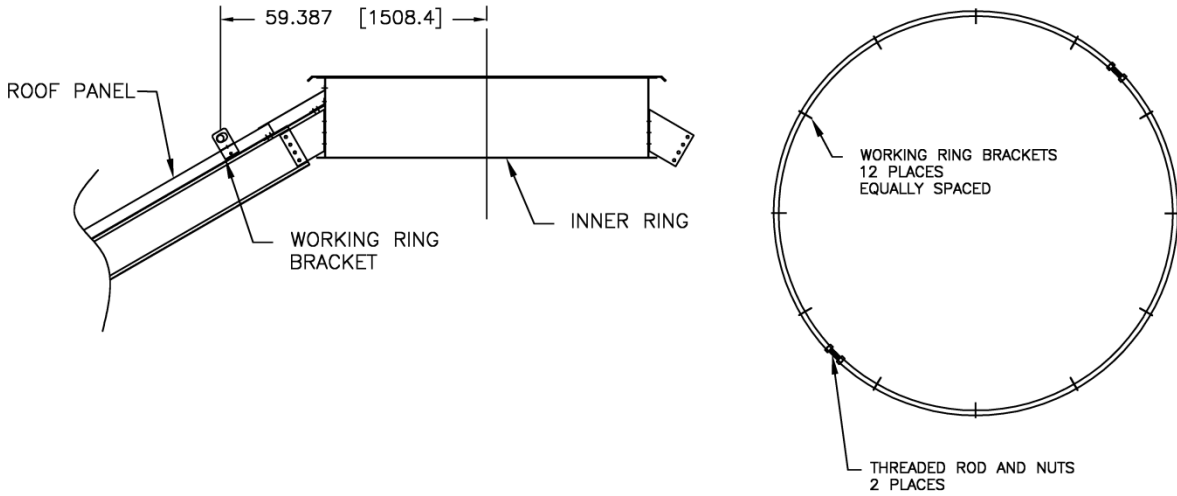

Roof Ladder

Install the roof ladder as shown in the following illustration. The roof ladder will be located adjacent to the manhole and roof rafter. Verify that quantities of specific length components are located correctly on the roof.

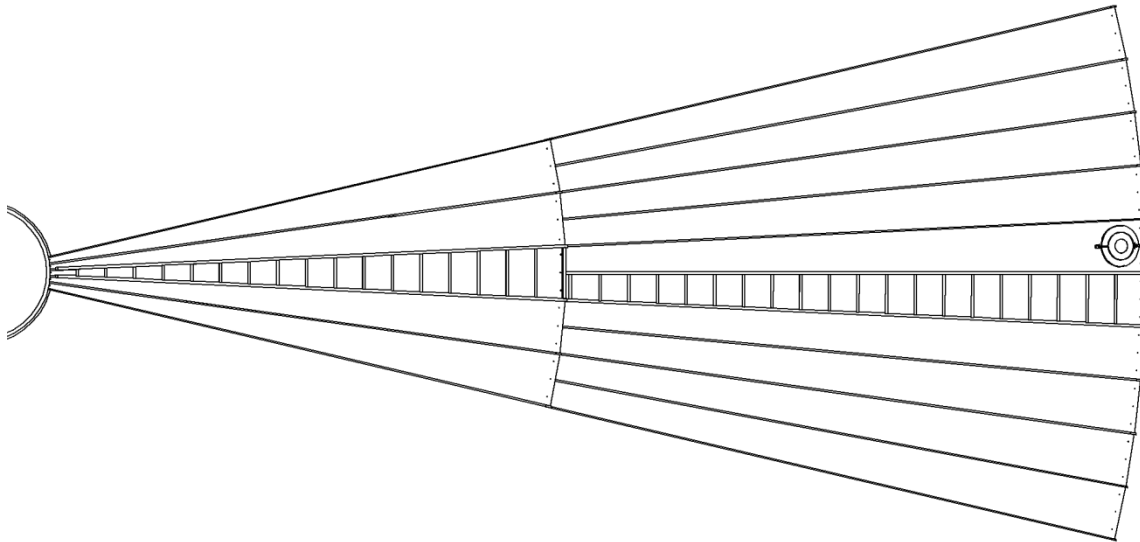

Bin Size	Rail 54"	Rail 72"	Rail 90"	Rail 108"
CB13				4

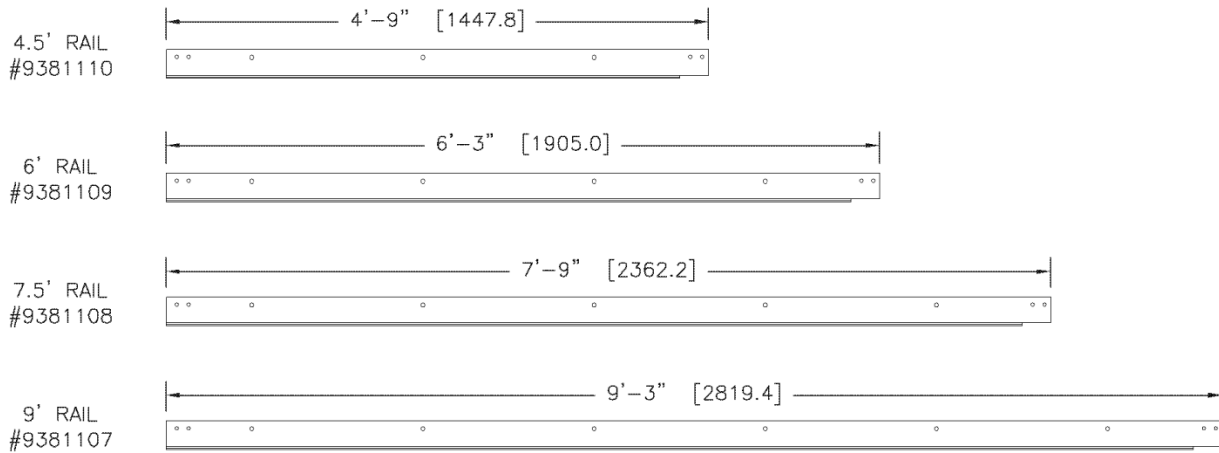

Attach the roof ladder rails to the roof panels by field drilling holes into the vertical rib of the roof panel. Secure the working ring brackets with 5/16" x 3/4" (.79x1.90cm) bin bolts. Roof ladder rungs will then be attached to the roof ladder rails and secured with 5/16" x 3/4" (.79x1.90cm) bin bolts.

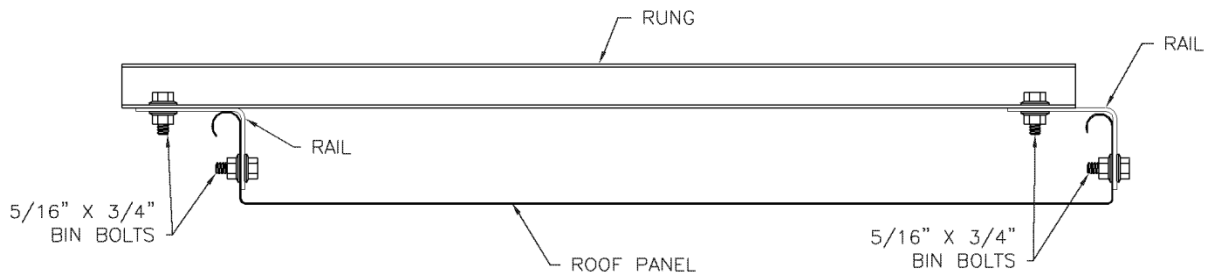

Working up from the roof eave to the roof peak, the rails will need to be overlapped when transitioning from 1 section of rails to the next. Overlap these rails as shown in the following illustration and secure the rails with 5/16" x 3/4" (.79x1.90cm) bin bolts.

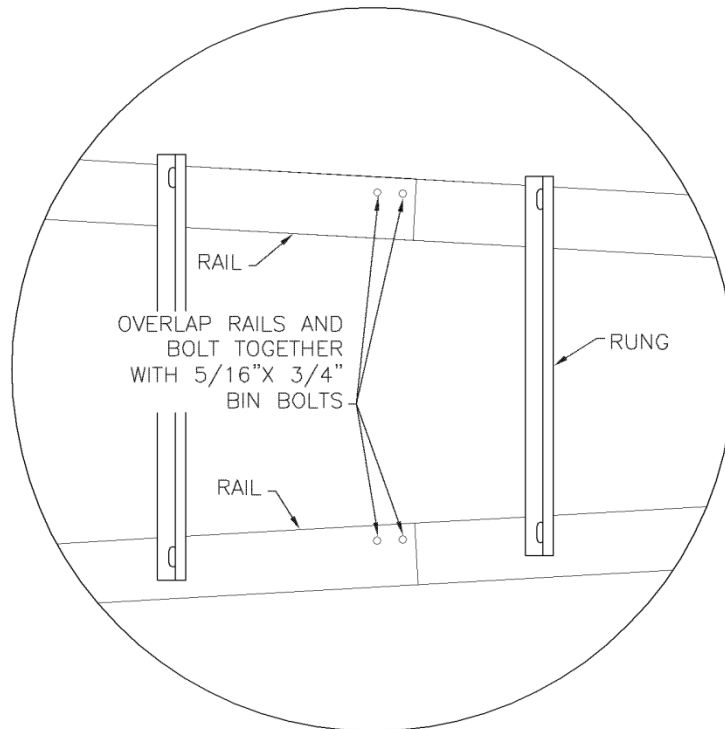

DETAIL A

Gooseneck Vents

Gooseneck vents are attached to pre-punched roof panels to provide proper airflow for aeration systems. **Note:** Proper planning is required to locate the pre-punched roof panels correctly during the roof installation.



The pre punched roof panels located in 3 separate locations and are required to be equally spaced around the bin during the roof installation. In addition to being equally spaced, the vents must be staggered correctly in 3 locations. 33% of the total vents are located in the standard upper panel location as shown in the following illustration.

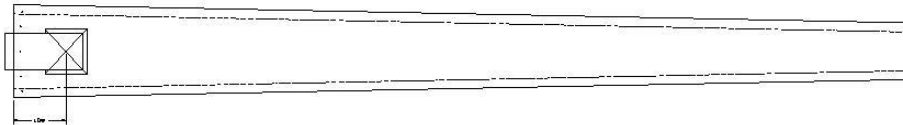

33% of the total vents are located in the low location of the lower panel, and 33% of the total vents are located in the high position of the lower panel as shown in the following illustration.

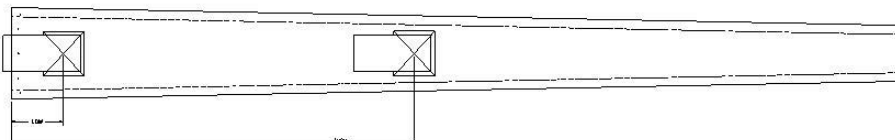

Locate the pre-punched vent location as shown in the following illustration and apply sealant to the perimeter of the pre-punched opening between the roof panel and the vent base. Secure the vent to the roof panel with 5/16" x 3/4" (.79x1.90cm) bin bolts. **Note:** Do not weld vents to the roof panels.



Low Profile Vents

Gooseneck vents are attached to pre-punched manway roof panels to provide proper airflow for aeration systems. **Note:** Proper planning is required to locate the pre-punched roof panels correctly during the roof installation.

Install the screen and clips on the roof vent body using 5/16" x 3/4" (.79x1.90cm) bin bolts, nuts and flat washers as shown below. The bolt heads should be located on the exterior of the vent with the washers and nuts on the inside against the screen.

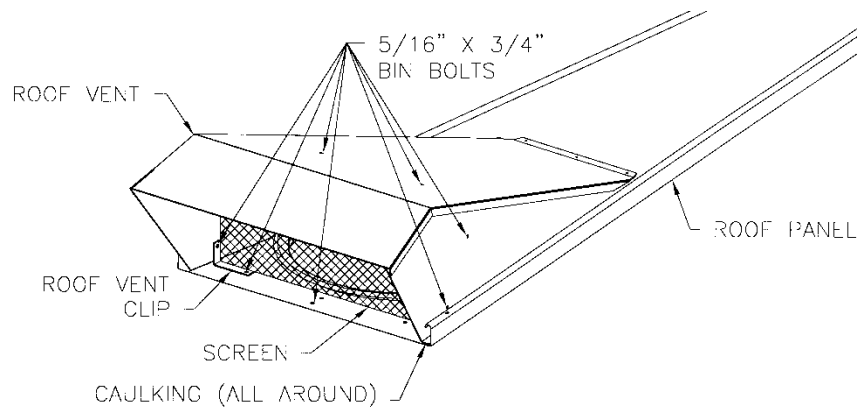

Locate the roof vent assembly on the roof panel (over the manhole) by aligning the holes in the clips with the corresponding holes in the lower end of the roof panel. Mark the outline of the roof vent with a marking pencil so that the vent can be returned to the same position after the caulking is applied.

Remove the vent from the roof panel, turn upside down, and apply sealant to the mounting surface of the sides and top. At this time, locate the roof vent in its original position and secure the vent using 5/16" x 3/4" (.79x1.90cm) bin bolts in the holes directly above and below the manhole.

Next install the #14 x 3/4" self-drilling screws use the holes in the vent as a guide. Alternatively, 3/8" (.95cm) holes can be drilled through the vent and roof panel to attach the vent with 5/16" x 3/4" (.79x1.90cm) bin bolts.

Finally install 5/16" x 3/4" (.79x1.90cm) bin bolts in the clips and bottom of screen as shown in the previous illustration.

Note: Roofs with structural beams may require field installation of angles between beams at both top and bottom of the manhole opening if 20 PSF or 30 PSF live loading is required.

Mushroom Vents

Mushroom vents are attached to pre-punched roof panels to provide proper airflow for aeration systems. **Note:** Proper planning is required to locate the pre-punched roof panels correctly during the roof installation.

Locate the pre-punched roof panel and apply sealant on the base of the extruded lip where the vent base will be located. Place the vent over the extruded lip and fasten with (8) #12x1.25" self-drilling screws equally spaced around the perimeter of the base.

Next fasten the rain diverter on the top of the vent towards the roof peak. Verify that the rain diverter makes contact with the roof panel. Fasten the rain diverter with (2) #12 x 1.25" self-drilling screws per side.

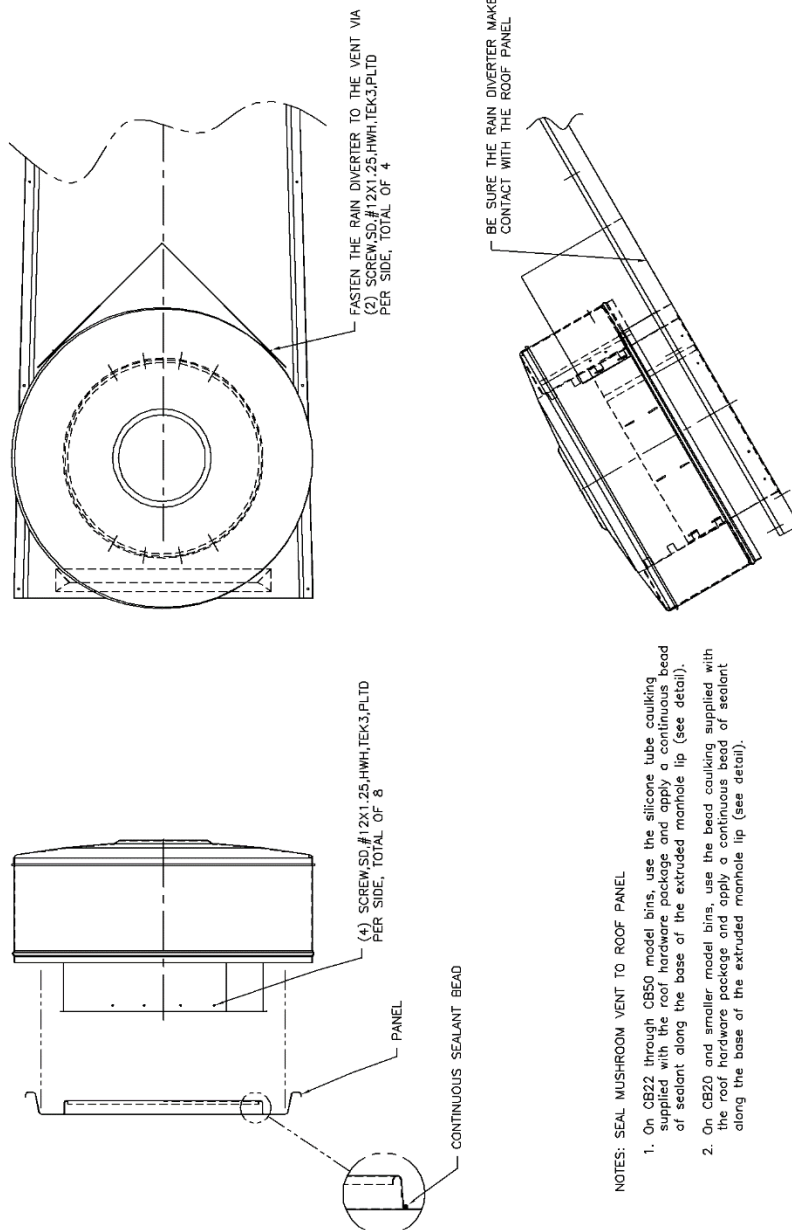

Safety Tie-Off Access Packages

Tie off anchors are provided at 2 locations on the bin. 1 is located at the bin eave manhole location and 1 is located at the bin peak. Attach tie-off anchor locations to wall and peak ring as shown in the following illustrations.

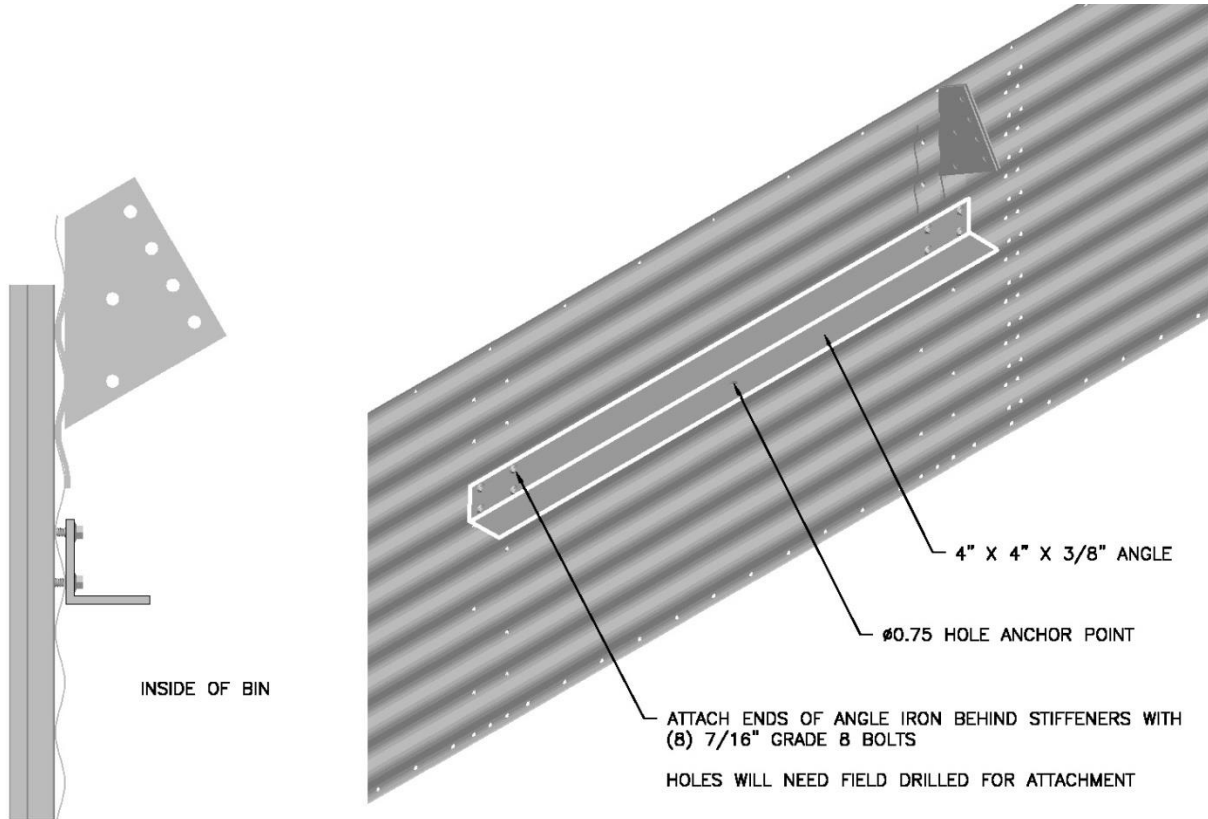

On 3 stiffened bins, place a 1/2" shim between angle and sidewall sheet.

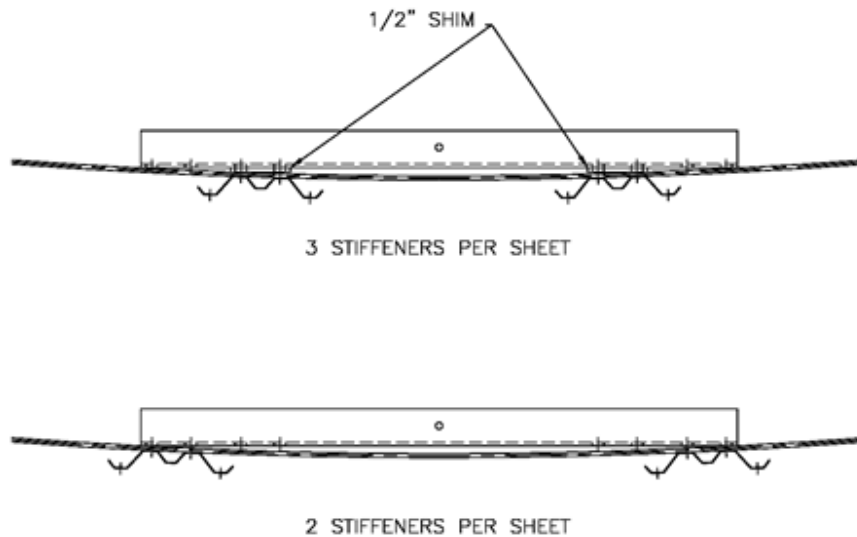

An additional safety tie-off point is located on the bin peak ring.

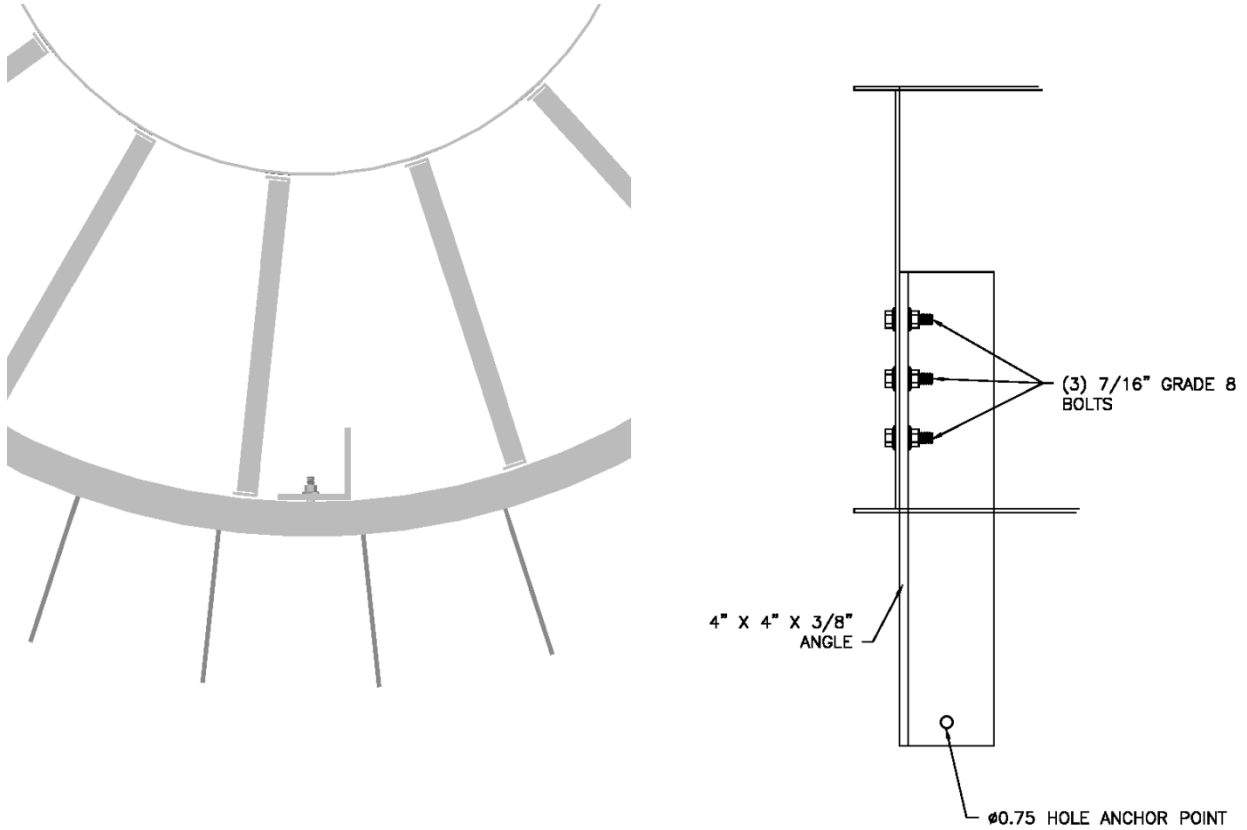

Temperature Cable Packages

For all temperature cable packages follow the temperature cable manufacturer’s recommendations and installation instructions. Provide adequate sealant where the temperature cable leads exit the bins.

Support of temperature cables by any means other than Chief Industries’ recommended brackets may cause structural damage to the bin roof and will nullify the Chief grain bin warranty.

Note: Structured roofs are designed for a maximum load of 2,000 lbs (907kg) per temperature cable. If this load is exceeded, this may cause structural damage to the bin roof and will nullify the Chief grain bin warranty.

Bin Size	Number of Temperature Cable	Radius From Bin Centerline
CB13	1	1’-8” (50.80cm)
	3	11’-6” (350.52cm)
Total Cables:	4	

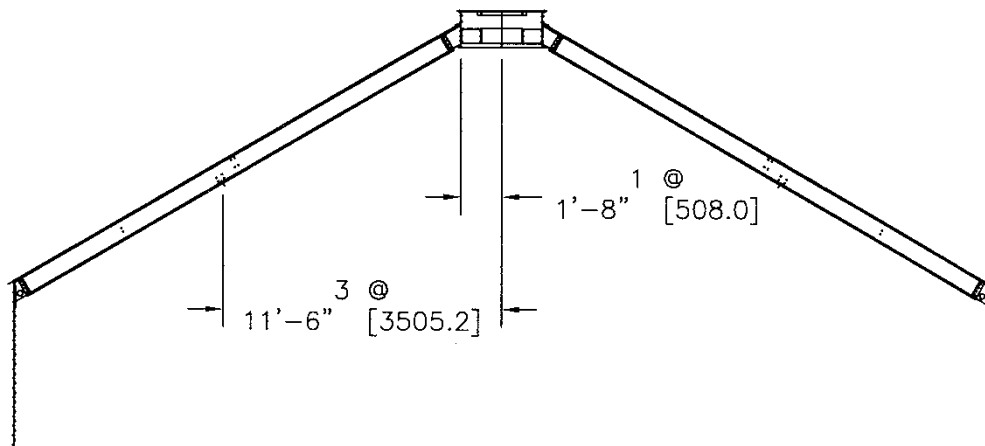
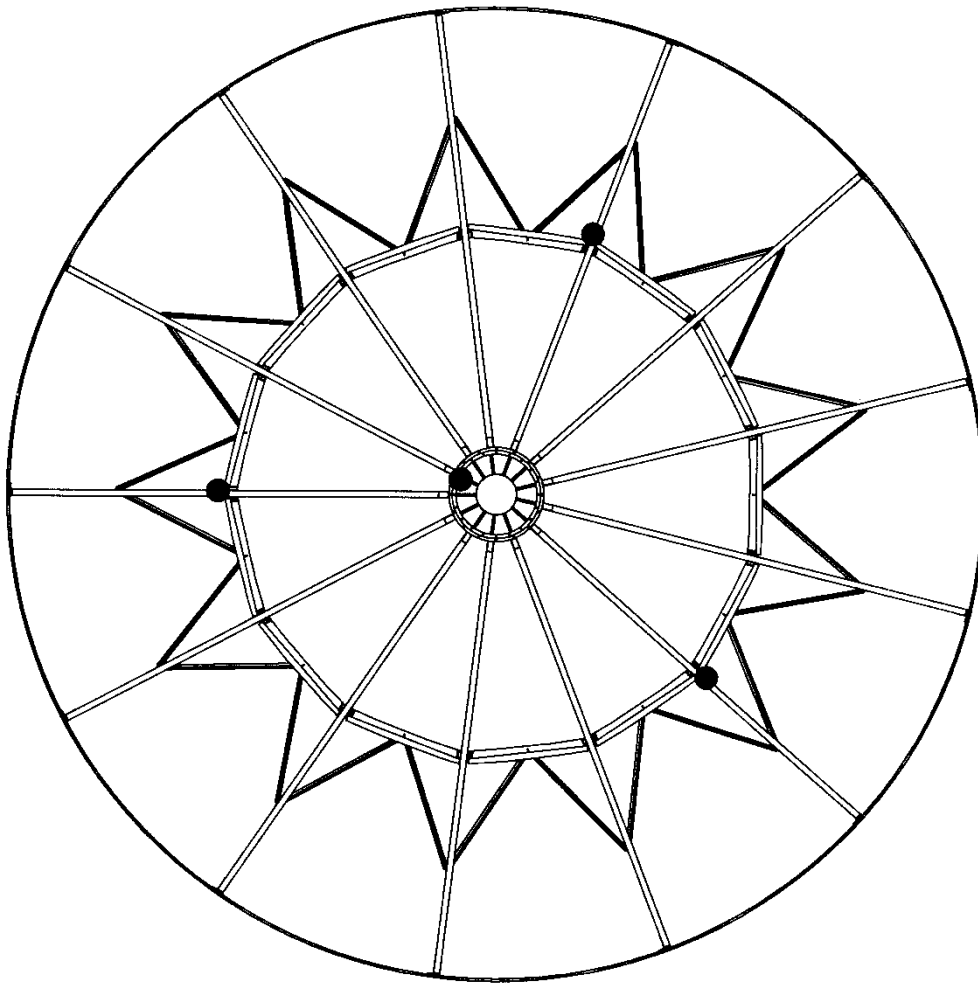

Do not attach temperature cables to roof rafters adjacent to a side draw unload system or in the same bay that a side draw unload system is located.

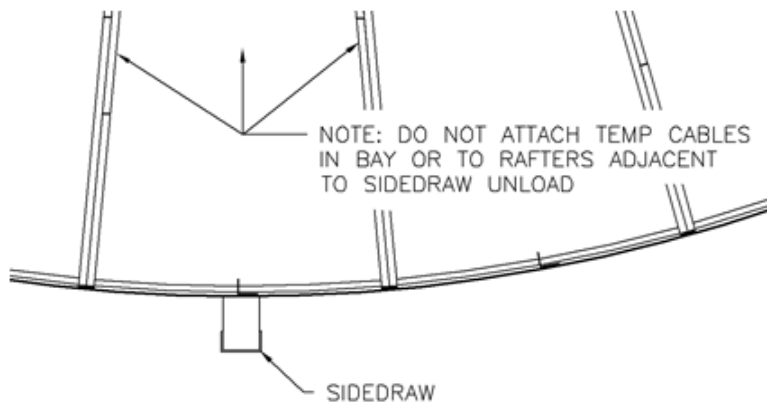

For bins 15 rings and shorter, install the temperature cable brackets as shown in the following illustration. Then attach the temperature cable eye bolt to the rafter using the temperature cable manufacturer's instructions. **Note:** Do not install more than 1 temperature cable per roof beam.

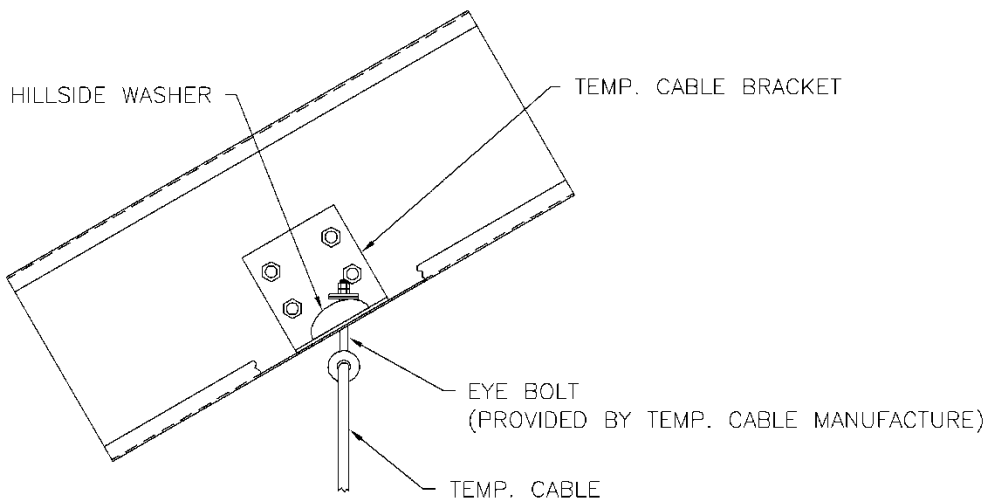
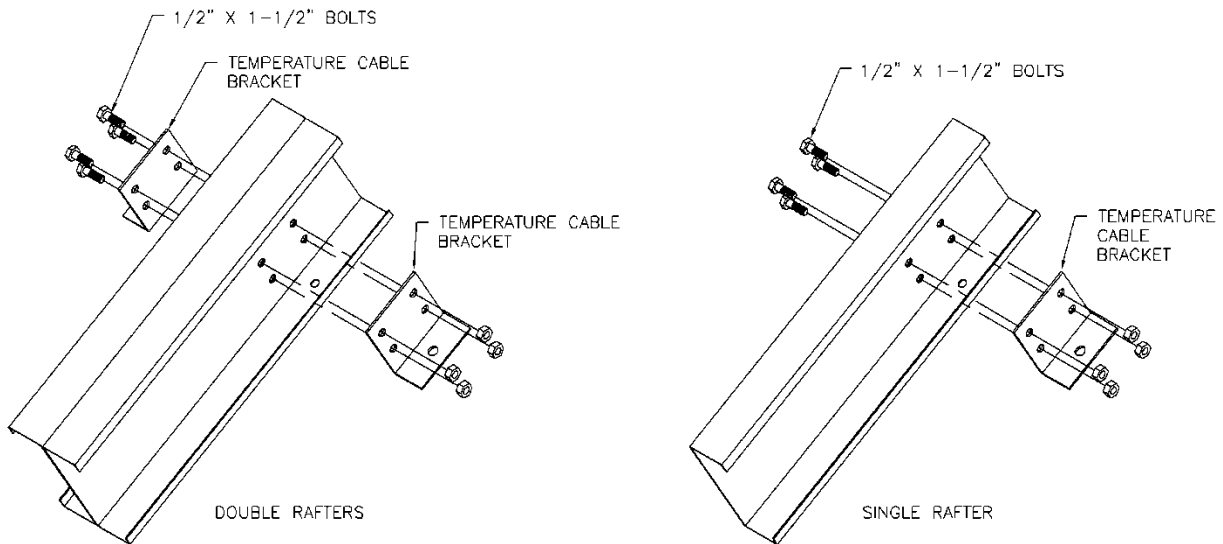

For bins 16 rings and taller, install the temperature cable brackets as shown in the following illustration. Then attach the temperature cable support beams to the bottom of the roof rafters, using pipe spacers as needed when roof x bracing interferes with the temperature cable beams. Then attach the temperature cable eye bolt to the support beam using the temperature cable manufacturer's instructions. **Note:** Do not install more than 1 temperature cable per roof beam.

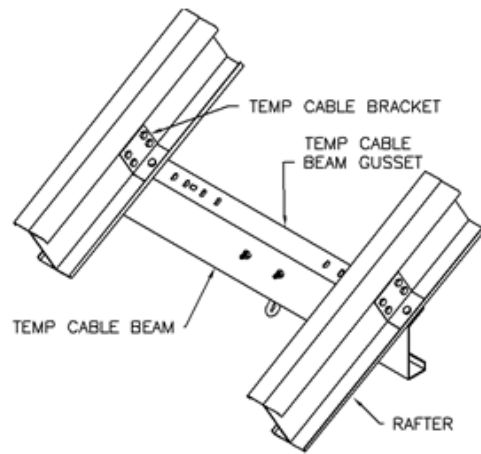
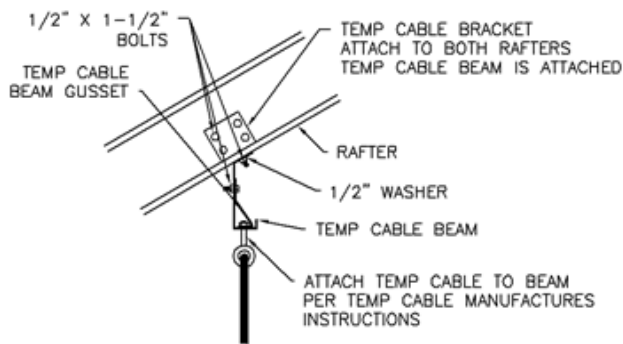
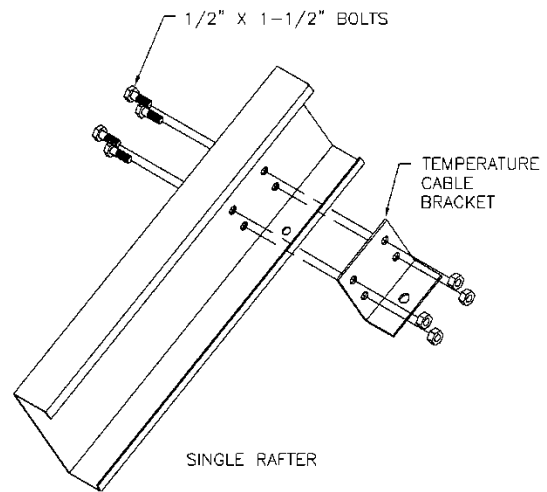
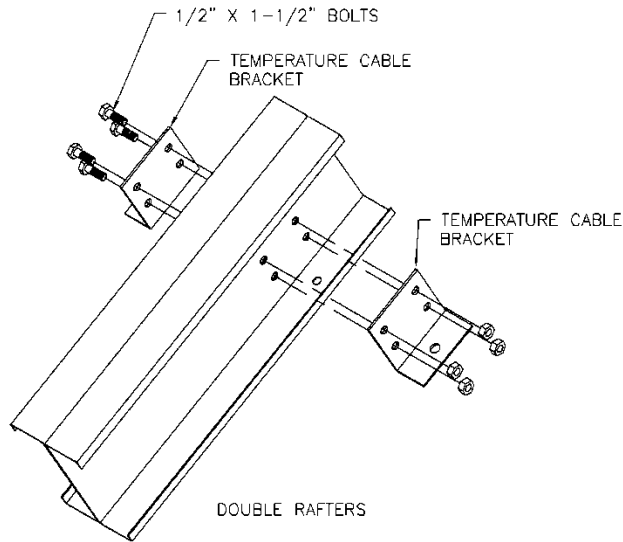

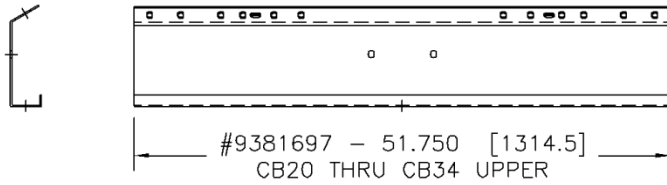
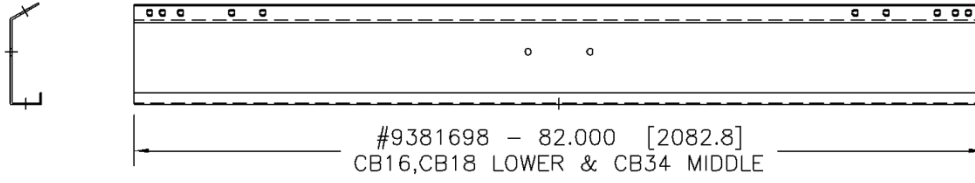
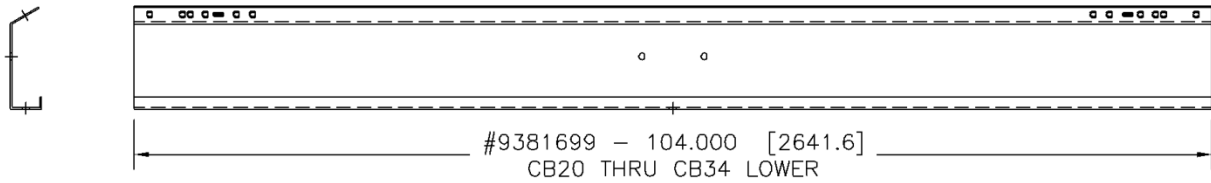

#9381696 - BEAM GUSSET

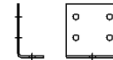

#9347784 - TEMP CABLE BRACKET

Manual Revisions

- 10-1-2015
 - General formatting update

STANDARD LIMITED WARRANTY

Chief Grain Bin Products

1. **Definitions.** The following terms, when they appear in the body of this Standard Limited Warranty for Grain Bin Products in initial capital letters shall have the meaning set forth below:
 - A. Accepted Purchase Order shall mean the Purchase Order identified below.
 - B. Chief shall mean Chief Agri/Industrial, a division of Chief Industries, Inc.
 - C. Original Owner shall mean the original owner identified below.
 - D. Product shall mean the Agri/Industrial Equipment as described in the Accepted Purchase Order.
 - E. Reseller shall mean the authorized Chief Agri/Industrial Equipment dealer identified below.

2. **Limited Product Warranty.** Upon and subject to the terms and conditions set forth below, Chief hereby warrants to the Reseller, and, if different, the Original Owner as follows:
 - A. All new Products delivered to the Reseller or the Original Owner by Chief pursuant to the Accepted Purchase Order will, when delivered, conform to the specifications set forth in the Accepted Purchase Order;
 - B. All new Products delivered pursuant to the Accepted Purchase Order will, in normal use and service, be free from defects in materials or workmanship; and
 - C. Upon delivery, Chief will convey good and marketable title to the Products, free and clear of any liens or encumbrances except for, where applicable, a purchase money security interest in favor of Chief.

3. **Duration of Warranty and Notice Requirements.** Subject to the **Exceptions, Exclusions and Limitations** set forth below, the warranties set forth in Section 2 above shall apply to all covered non-conforming conditions that are discovered within the first sixty (60) months following delivery of the Product to the carrier designated by the Reseller and/or the Original Owner at Chief's manufacturing facility in Kearney, Nebraska (the "Warranty Period") and are reported to the Chief as provided in Section 4 below within thirty (30) days following discovery (a "Notice Period").

4. **Notice Procedure.** In order to make a valid warranty claim, the Reseller and/or the Original Owner must provide Chief with a written notice of any nonconforming condition discovered during the Warranty Period within the applicable Notice Period specified in Section 3 above. Said notice must be in writing; be addressed to Chief Industries, Inc., Agri/Industrial Division, Customer Service Department, P.O. Box 848, Kearney, NE 68848; and contain the following information: (a) the Customer's name and address; (b) the Reseller's name and address; (c) the make and model of the Product in question; (d) the current location of the Product; (e) a brief description of the problem with respect to which warranty coverage is claimed; and (f) the date on which the Product was purchased.

5. **Exceptions and Exclusions.** Anything herein to the contrary notwithstanding, the warranties set forth in Section 2 above do **not** cover any of the following, each of which are hereby expressly excluded:
 - A. Defects that are not discovered during the applicable Warranty Period;
 - B. Defects that are not reported to the Chief Agri/Industrial Division Customer Service Department in conformity with the notice procedure set forth in Section 4 above within the applicable Notice Period specified in Section 3;
 - C. Any used or pre-owned Products;
 - D. Any Chief manufactured parts that are not furnished as a part of the Accepted Purchase Order;
 - E. Any fixtures, equipment, materials, supplies, accessories, parts or components that have been furnished by Chief but are manufactured by a third party;
 - F. Any Products which have been removed from the location at which they were originally installed;
 - G. Any defect, loss, damage, cost or expense incurred by the Reseller or the Original Owner to the extent the same arise out of, relate to or result, in whole or in part, from any one or more of the following:

- (i) Usual and customary deterioration, wear or tear resulting from normal use, service and exposure;
- (ii) Theft, vandalism, accident, war, insurrection, fire or other casualty;
- (iii) Any damage, shortages or missing parts which result during shipping or are otherwise caused by the Reseller, the Original Owner and/or any third party;
- (iv) Exposure to marine environments, including frequent or sustained salt or fresh water spray;
- (v) Exposure to corrosive, chemical, ash, smoke, fumes, or the like generated or released either within or outside of the structure on which the Product is installed, regardless of whether or not such facilities are owned or operated by the Reseller, the Original Owner or an unrelated third party;
- (vi) Exposure to or contact with animals, animal waste and/or decomposition;
- (vii) The effect or influence the Product may have on surrounding structures, including, without limitation, any loss, damage or expense caused by drifting snow;
- (viii) Any Product or portion thereof that has been altered, modified or repaired by the Reseller, the Original Owner or any third party without Chief's prior written consent;
- (ix) Any Product or portion thereof that has been attached to any adjacent structure without Chief's prior written approval;
- (x) Any Product to which any fixtures, equipment, accessories, materials, parts or components which were not provided as a part of the original Accepted Purchase Order have been attached without Chief's prior written approval;
- (xi) The failure on the part of the Reseller, the Original Owner or its or their third party contractors to satisfy the requirements of all applicable statutes, laws, ordinances rules, regulations and codes, (including zoning laws and/or building codes);
- (xii) The use of the Product for any purpose other than the purpose for which it was designed; and/or
- (xiii) The failure of the Reseller, the Original Owner and/or any third party to:
 - (a) properly handle, transport and/or store the Product or any component part thereof;
 - (b) properly select and prepare a site that is adequate for the installation and/or operation of the Product or any component part thereof;
 - (c) properly design and construct a foundation that is adequate for the installation and/or operation of the Product or any component part thereof;
 - (d) properly set up, erect, construct or install the Product and/or any component part thereof; and/or
 - (e) properly operate, use, service and/or maintain the Product and each component part thereof.

6. **Resolution of Warranty Claims.** In the event any nonconforming condition is discovered within the Warranty Period and Chief is notified of a warranty claim as required by Section 4 prior to the end of the applicable Notice Period set forth in Section 3 above, Chief shall, with the full cooperation of the Reseller and the Original Owner, immediately undertake an investigation of such claim. To the extent Chief shall determine, in its reasonable discretion, that the warranty claim is covered by the foregoing Limited Product Warranty, the following shall apply:

A. Warranty Claims With Respect to Covered Non-Conforming Conditions Discovered Within the First Three Hundred Sixty Five (365) Days and Reported to Chief Within Thirty (30) Days of Discovery. In the case of a warranty claim which relates to a covered non-conforming condition that is discovered during the first three hundred sixty five (365) days of the Warranty Period and is reported to Chief as required by Section 4 within thirty (30) days of discovery as required by Section 3, Chief will, as Chief's sole and exclusive obligation to the Reseller and the Original Owner, and as their sole and exclusive remedy, work in cooperation with the Reseller and the Original Owner to correct such non-conforming condition, and in connection therewith, Chief will ship any required replacement parts to the "ship to address" set forth in the Accepted Purchase Order FOB Chief's facilities in Kearney, Nebraska, and will either provide the labor or reimburse the Reseller or the Original Owner, as may be appropriate in the circumstances, for any out of pocket expense the Original Owner may reasonably and necessarily incur for the labor that is required to correct such non-conforming condition, provided that if work is to be performed by the Reseller or a third party contractor, Chief may require at least two competitive bids to perform the labor required to repair or correct the defect and reserves the right to reject all bids and obtain additional bids. Upon acceptance of a bid by Chief, Chief will authorize the necessary repairs.

- B. **All Other Warranty Claims.** Except as is otherwise provided in subsection 6A above, in the case of all other warranty claims which relate to covered non-conforming conditions that are discovered during the Warranty Period and are reported to Chief as required by Section 4 within thirty (30) days following discovery, Chief will, as Chief's sole and exclusive obligation to the Reseller and the Original Owner, and as the Reseller's and the Original Owner's sole and exclusive remedy, ship any required replacement parts to the Original Owner at the "ship to address" specified in the Accepted Purchase Order FOB Chief's facilities in Kearney, Nebraska; and **in such event, Chief shall have no responsibility or liability to either the Reseller or the Original Owner for the cost of any labor required to repair or correct the defect.**
7. **Warranty Not Transferable.** This Warranty applies only to the Reseller and the Original Owner and is **not transferable.** As such, this Warranty does **not** cover any Product that is sold or otherwise transferred to any third party following its delivery to the Original Owner.
8. **Limitation on Warranties, Liabilities and Damages.** The Reseller and the Original Owner expressly agree that the allocation of the risk, liability, loss, damage, cost and expense arising from any Product that does not conform to the limited warranty given in Section 2 above are fair and reasonable and acknowledge that such allocation was expressly negotiated by the parties and was reflected in the Purchase Price of the Product. Accordingly the Reseller and the Original Owner expressly agree as follows:
- A. **Disclaimer of Implied Warranties.** **EXCEPT AS IS OTHERWISE EXPRESSLY SET FORTH HEREIN, CHIEF MAKES NO OTHER REPRESENTATIONS OR WARRANTIES OF ANY KIND WHATSOEVER, WHETHER EXPRESS OR IMPLIED, BY OPERATION OF LAW, COURSE OF DEALING OR OTHERWISE WITH RESPECT TO THE PRODUCT, ANY COMPONENT PART THEREOF OR ANY OTHER GOODS OR SERVICES THAT CHIEF MANUFACTURES, FABRICATES, PRODUCES, SELLS OR PROVIDES TO THE DEALER OR THE ORIGINAL OWNER PURSUANT TO THE TERMS OF ANY ACCEPTED PURCHASE ORDER, INCLUDING WITHOUT LIMITATION ANY REPRESENTATION OR WARRANTY WITH RESPECT TO DESIGN, CONDITION, MERCHANTABILITY OR FITNESS OF THE PRODUCT OR ANY OTHER GOODS OR SERVICES FOR ANY PARTICULAR PURPOSE OR USE.**
- B. **Limitation on Liability.** **EXCEPT AS IS OTHERWISE EXPRESSLY SET FORTH IN SECTION 6 ABOVE, CHIEF'S LIABILITY TO THE DEALER AND/OR THE ORIGINAL OWNER WITH RESPECT TO ANY DEFECTS IN ANY PRODUCTS OR FOR ANY OTHER GOODS OR SERVICES WHICH DO NOT CONFORM TO THE WARRANTIES SET FORTH ABOVE SHALL NOT, IN ANY EVENT, EXCEED THE ACTUAL COST OF SUCH NON-CONFORMING PRODUCT, GOODS OR SERVICES AS DETERMINED PURSUANT TO THE ACCEPTED PURCHASE ORDER; AND**
- C. **Limitation on the Nature of Damages.** **EXCEPT AS EXPRESSLY PROVIDED IN SECTION 6 ABOVE, CHIEF SHALL NOT, UNDER ANY CIRCUMSTANCES, BE LIABLE TO THE DEALER, THE ORIGINAL OWNER OR ANY THIRD PARTY FOR ATTORNEY FEES COURT COSTS OR ANY OTHER SPECIAL, INDIRECT, INCIDENTAL, CONSEQUENTIAL, LIQUIDATED OR PUNITIVE DAMAGES OF ANY NAME, NATURE OR DESCRIPTION AS A RESULT OF THE FAILURE OF ANY PRODUCT OR ANY OTHER GOODS OR SERVICES PURCHASED BY THE DEALER OR THE ORIGINAL OWNER FROM CHIEF PURSUANT TO THE ACCEPTED PURCHASE ORDER TO CONFORM TO THE LIMITED WARRANTIES SET FORTH IN SECTION 2 ABOVE.**
8. **Applicable Law.** This Limited Product Warranty has been issued, accepted and entered into by the Reseller, the Original Owner and Chief in the State of Nebraska and shall be governed by, and construed in accordance with, the internal laws of the State of Nebraska. Any legal action or proceeding with respect to any goods or services furnished to the Original Owner by Chief in connection herewith, or any document related hereto shall be brought only in the district courts of Nebraska, or the United States District Court for the District of Nebraska, and, by execution and delivery of this Limited Product Warranty, the undersigned Original Owner hereby accept for themselves and with respect to their property, generally and unconditionally, the jurisdiction of the aforesaid courts. Further, the undersigned Original Owner hereby irrevocably waives any objection, including, without limitation, any *forum non conveniens*, which it may now or hereafter have to the bringing of such action or proceeding in such respective jurisdictions.

ACKNOWLEDGMENT OF RECEIPT

By its signature hereto, the undersigned Reseller represents and warrants to Chief that the Reseller has provided a true, correct and complete copy of this Standard Limited Warranty to the Original Owner at the time the product was purchased.

Reseller Name and Address: _____

Original Owner Name and Address: _____

Accepted Purchase Order No. _____

Original Jobsite Address: _____

RESELLER:

By: _____ Date

Print name and title

4843-5948-9057, v. 1



Should you have any questions concerning assembly instructions, parts or drawings, please feel free to contact us at any of the following.

© Chief Industries, Inc. Inc.
4400 East 39th Street • PO Box 848
Kearney, NE 68847
Phone 800.359.7600

For more information about Chief Industries, Inc. and additional products or services visit our website
www.agri.Chiefind.com